

ADF delivery guide (clear mylar sheet)



NOTE Replacement ADF delivery guide mylar sheets are located in an envelope behind the white mylar sheet.

1. Open the ADF/scanner assembly and release the two tabs at the top and bottom of the ADF delivery guide cover.

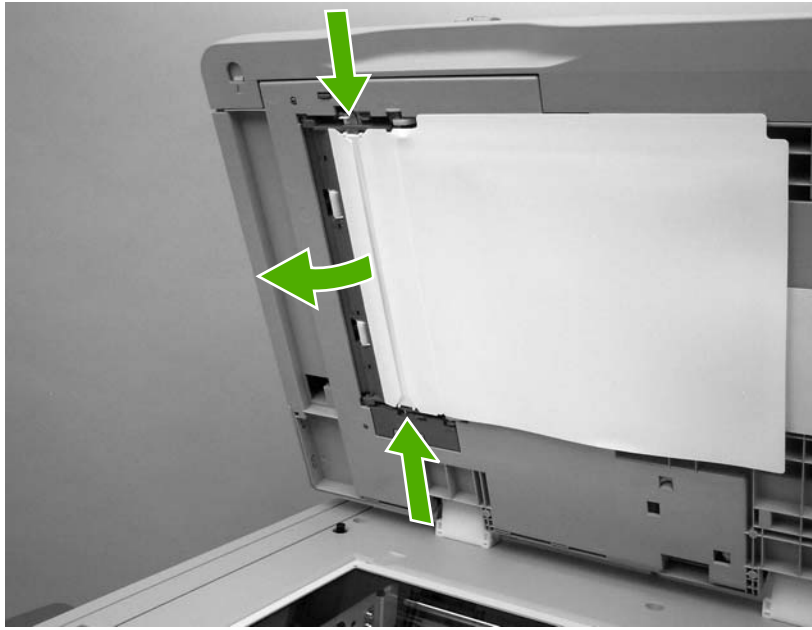

Figure 6-39 Remove the ADF delivery guide (1 of 3)

2. Carefully unhook the clear mylar sheet from the four tabs on the ADF delivery guide cover (callout 1), and then remove the mylar sheet.

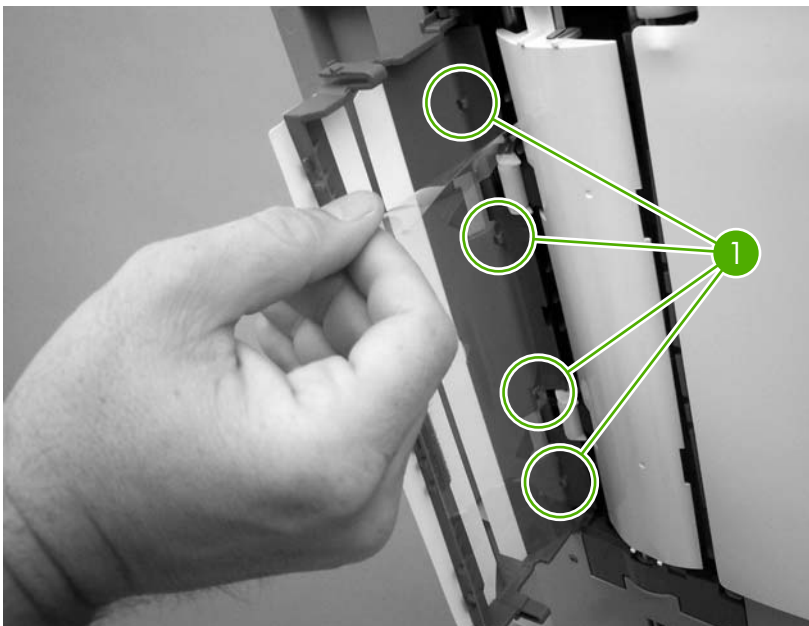

Figure 6-40 Remove the ADF delivery guide (2 of 3)

3. If it is difficult to replace the mylar strips, pull the ADF delivery guide cover hinges off the hinge pins (callout 2) to remove the cover.

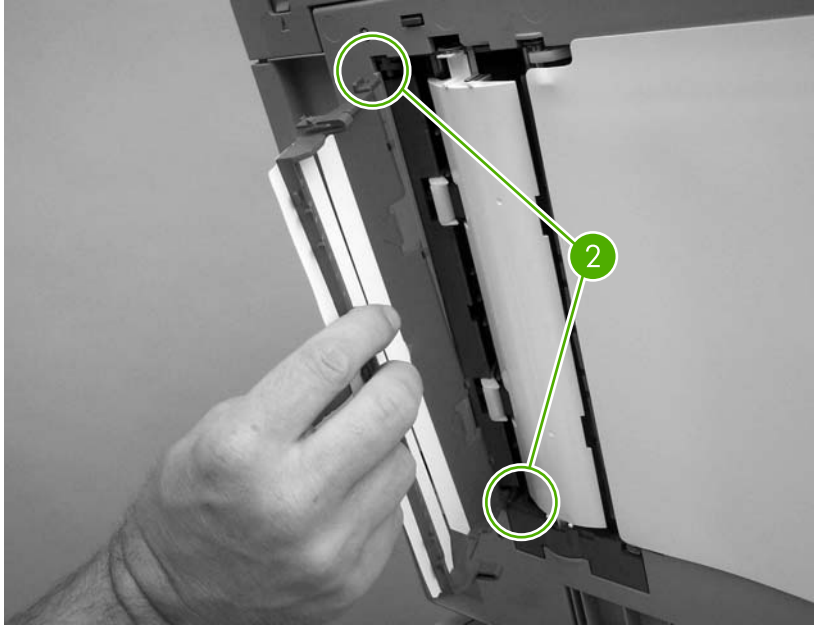

Figure 6-41 Remove the ADF delivery guide (3 of 3)

4. **Reinstallation tip:** The clear mylar sheet is keyed with a small notch at the top. Be sure to align the notch with the round pin that is on the holder.

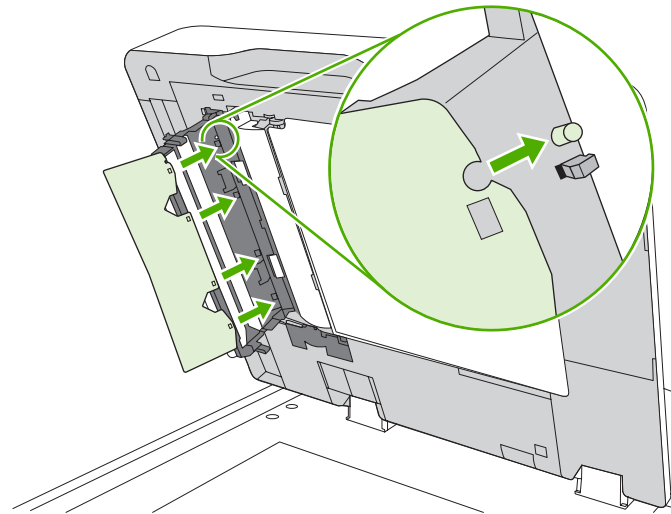

Figure 6-42 Reinstall the clear mylar sheet

ADF pickup and feed rollers

1. Open the ADF top cover.



Figure 6-32 Remove the ADF pickup and feed rollers (1 of 3)

2. Push down on the locking tab (callout 1), and rotate the top of the assembly away from the ADF.

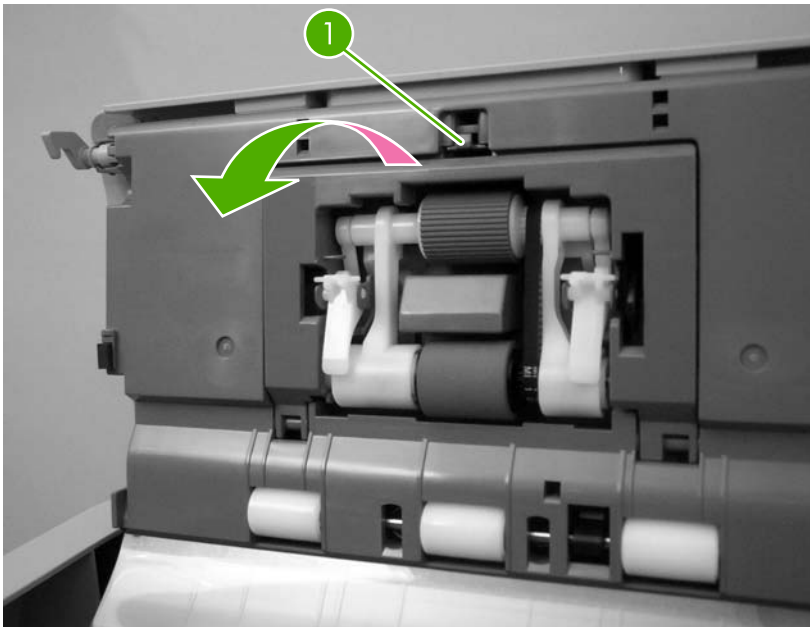

Figure 6-33 Remove the ADF pickup and feed rollers (2 of 3)

3. Release the front (gear end) of the roller assembly drive shaft (callout 2), and slide (callout 3) the assembly toward the front of the MFP to remove it.

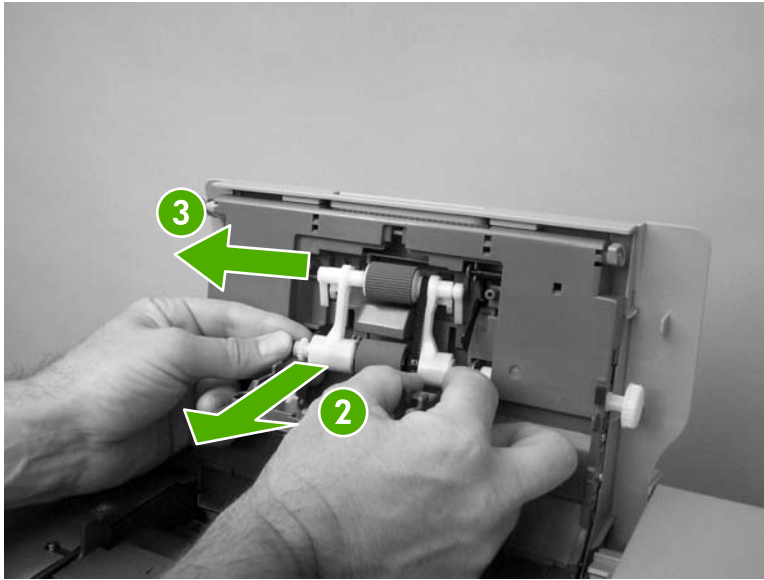

Figure 6-34 Remove the ADF pickup and feed rollers (3 of 3)

ADF separation pad

1. Open the ADF top cover.



Figure 6-35 Remove the ADF separation pad (1 of 4)

2. Locate the ADF separation pad (callout 1).



Figure 6-36 Remove the ADF separation pad (2 of 4)

3. Raise the separation pad frame assembly using the green lever, and push the bottom edge (white plastic) of the separation pad away from the frame.



Figure 6-37 Remove the ADF separation pad (3 of 4)

4. Push the separation pad out of the frame.



Figure 6-38 Remove the ADF separation pad (4 of 4)

2. Disconnect the cable (callout 1).



Figure 6-21 Remove the 3-bin mailbox (2 of 3)

3. Lift the 3-bin mailbox, tilt it upward, and pull to remove it from the MFP.

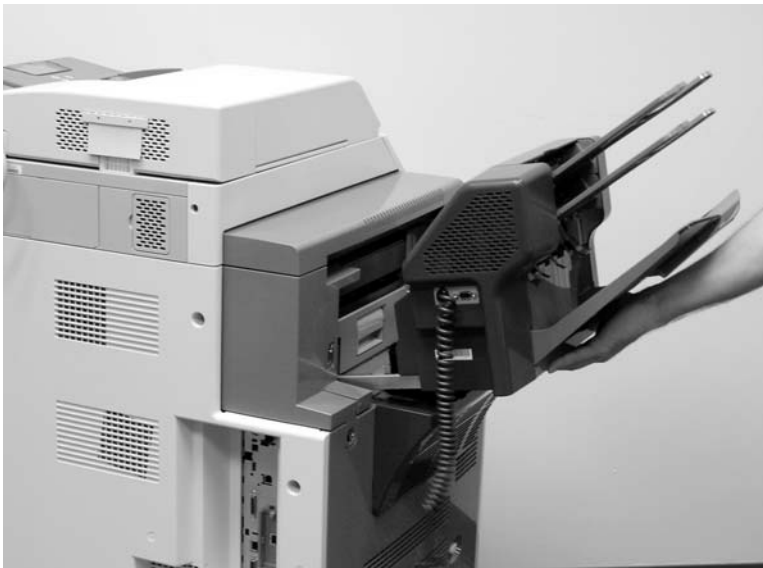

Figure 6-22 Remove the 3-bin mailbox (3 of 3)

ETB assembly, removing

1. Open the right lower cover.

2. Open the ETB assembly by pulling the green handle.



Figure 6-23 Remove the ETB assembly (1 of 4)

3. Depress the blue tabs on the right and left sides of the ETB (callout 2), and then lift the ETB (callout 1) out of the MFP.

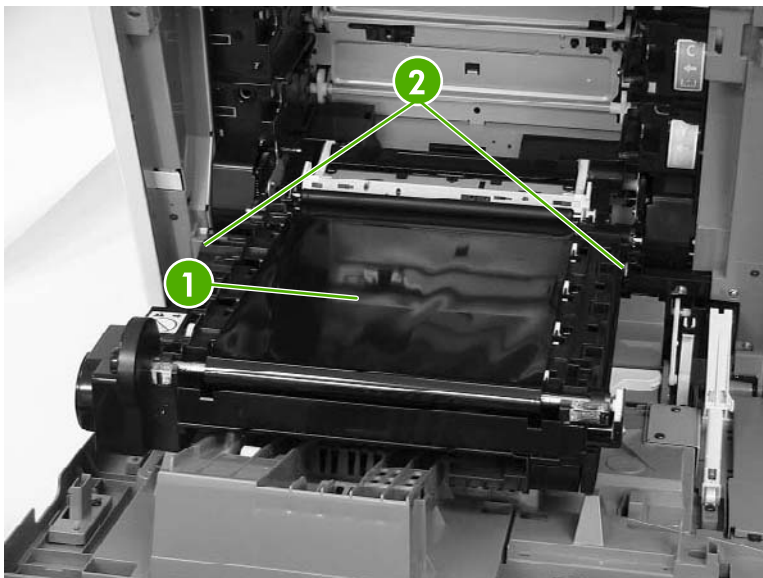

Figure 6-24 Remove the ETB assembly (2 of 4)

4. Detail of right lever (callout 3).

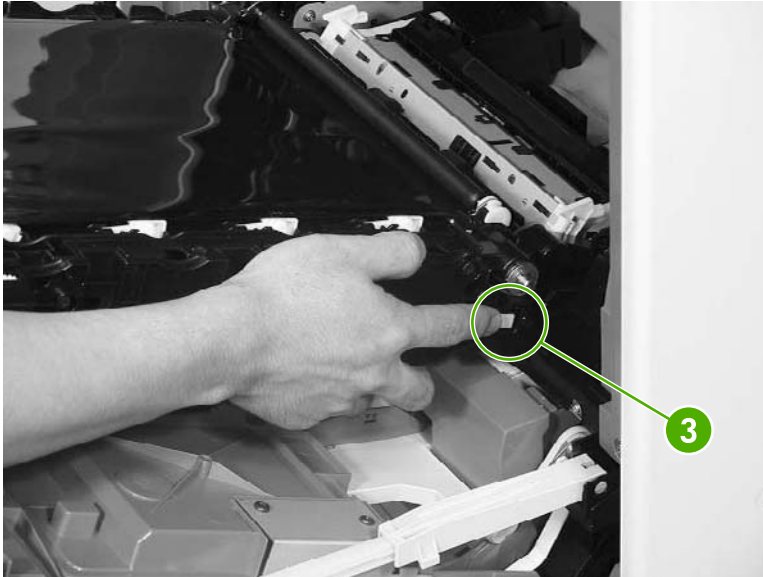

Figure 6-25 Remove the ETB assembly (3 of 4) — right lever

5. Detail of left lever (callout 4).

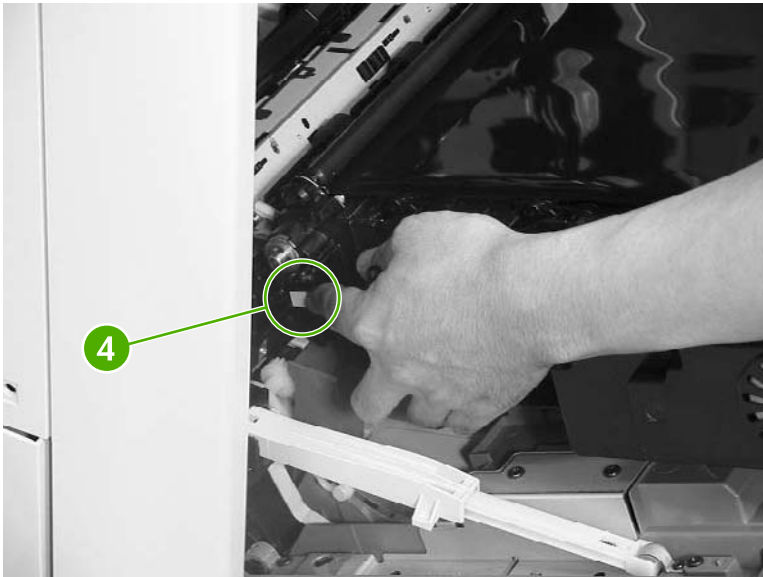

Figure 6-26 Remove the ETB assembly (4 of 4) — left lever

Fuser



NOTE Do not attempt to disassemble the fuser sleeve assembly. This part cannot be serviced in the field.

1. Open the right top cover (callout 1) and the fuser cover (callout 2).

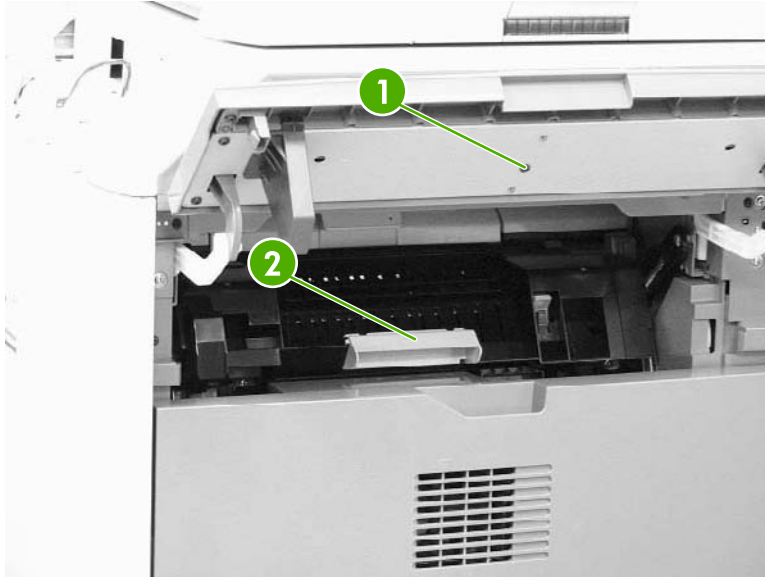

Figure 6-44 Remove the fuser (1 of 2)

2. Gently lift the two purple handles (callout 3). Then pull the fuser (callout 4) out of the MFP.

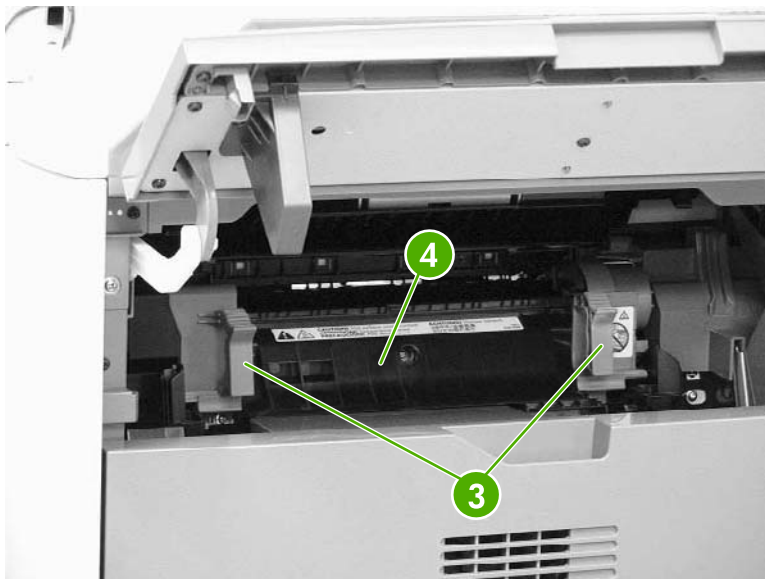

Figure 6-45 Remove the fuser (2 of 2)

MP tray pickup roller

1. Remove the MP tray pickup assembly. See [MP tray pickup assembly on page 261](#).
2. Slide the white tabs to the middle.

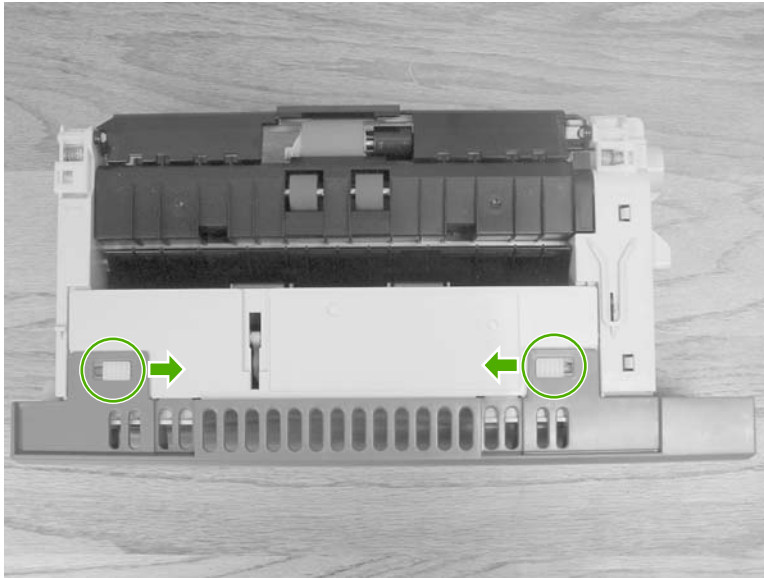

Figure 6-48 Remove the MP tray pickup roller (1 of 3)

3. Rotate the front cover away from the tray.

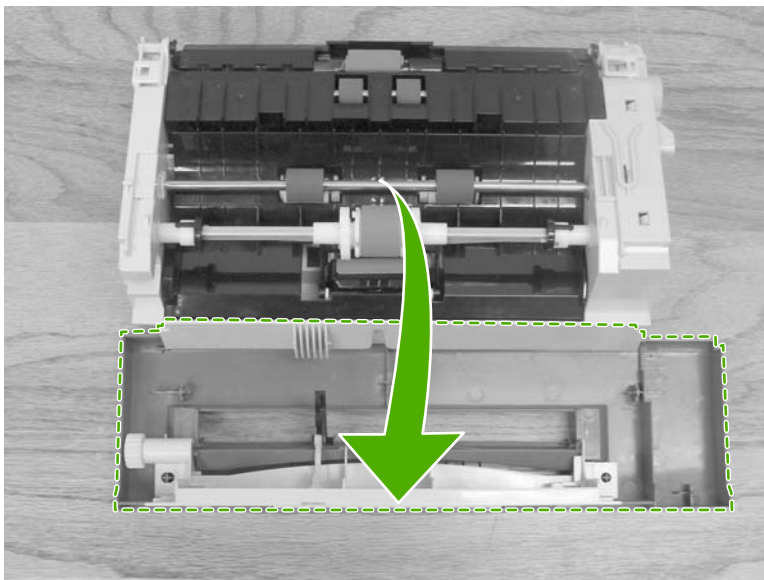

Figure 6-49 Remove the MP tray pickup roller (2 of 3)

4. Remove the pickup roller by pulling the tabs outward and lifting the roller from the shaft.

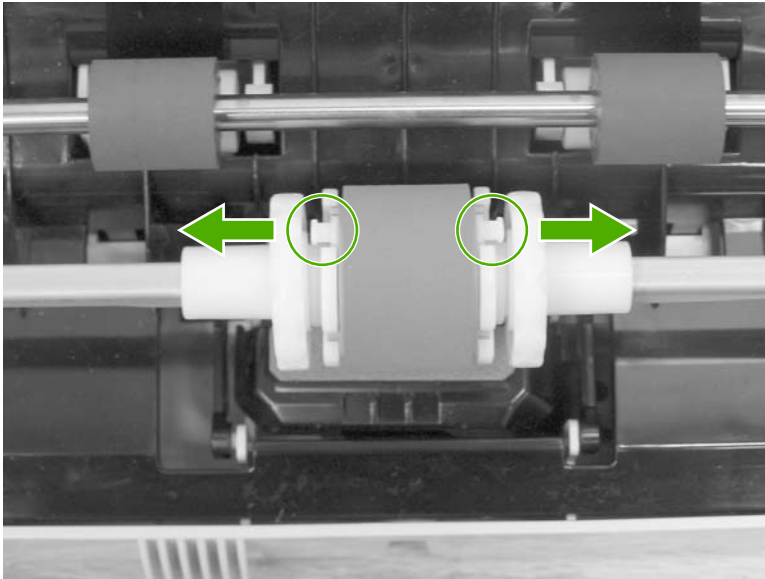

Figure 6-50 Remove the MP tray pickup roller (3 of 3)



Hint When reinstalling the MP tray pickup roller, insert the round tabs toward the front of the tray.

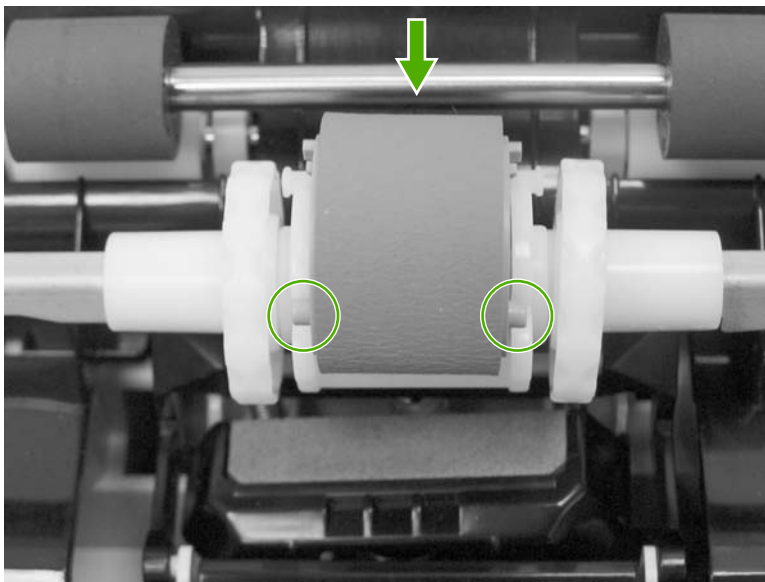

Figure 6-51 Replace the MP tray pickup roller

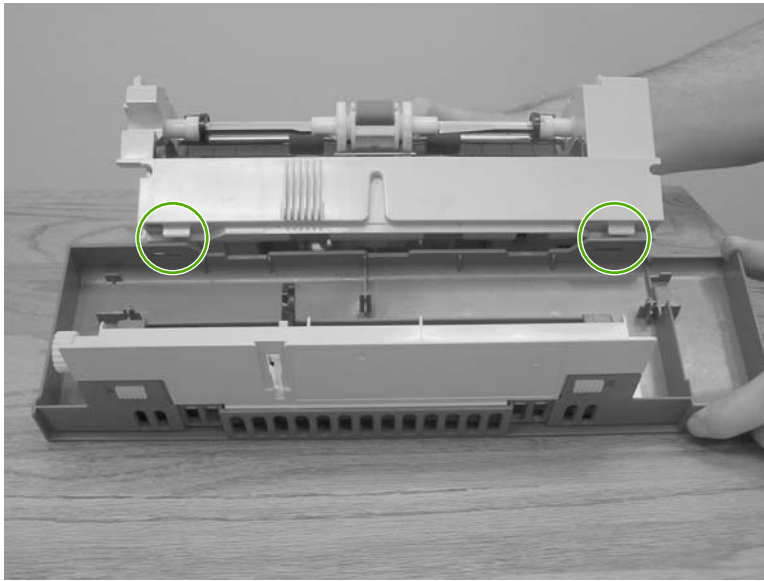

Figure 6-52 Replace the tray cover



Hint When reinstalling the tray front cover, insert the slots into the tabs, rotate the cover upward, and snap it into place.

Tray 2 separation roller

1. Remove the MP tray pickup assembly. See [MP tray pickup assembly on page 261](#).
2. Release the two locking tabs on the MP tray pickup assembly and open the tray 2 separation roller cover.

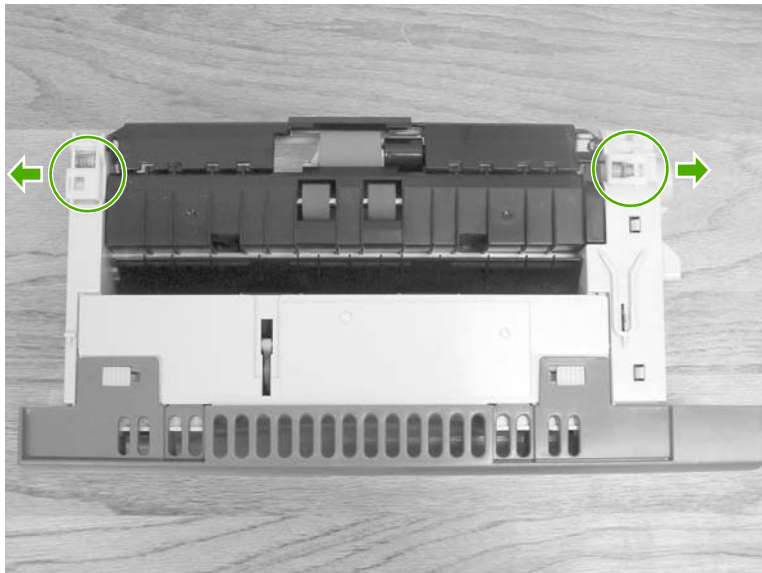

Figure 6-53 Remove the tray 2 separation roller (1 of 3)

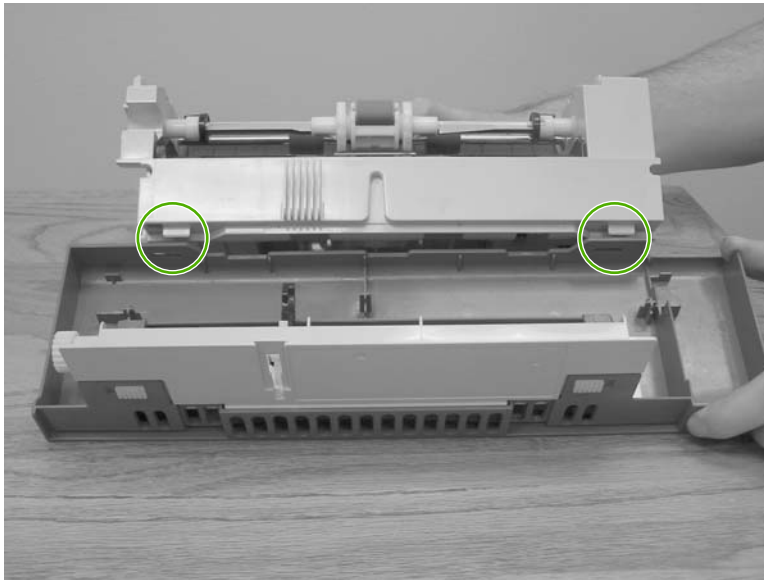

Figure 6-52 Replace the tray cover



Hint When reinstalling the tray front cover, insert the slots into the tabs, rotate the cover upward, and snap it into place.

Tray 2 separation roller

1. Remove the MP tray pickup assembly. See [MP tray pickup assembly on page 261](#).
2. Release the two locking tabs on the MP tray pickup assembly and open the tray 2 separation roller cover.

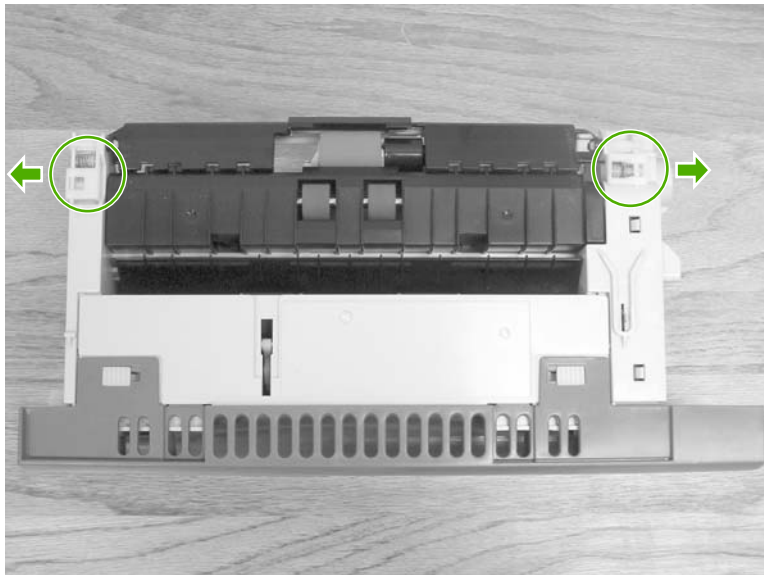

Figure 6-53 Remove the tray 2 separation roller (1 of 3)

3. Remove the tray 2 separation roller by depressing the blue tab and removing it from the shaft. Replace the tray 2 separation roller.

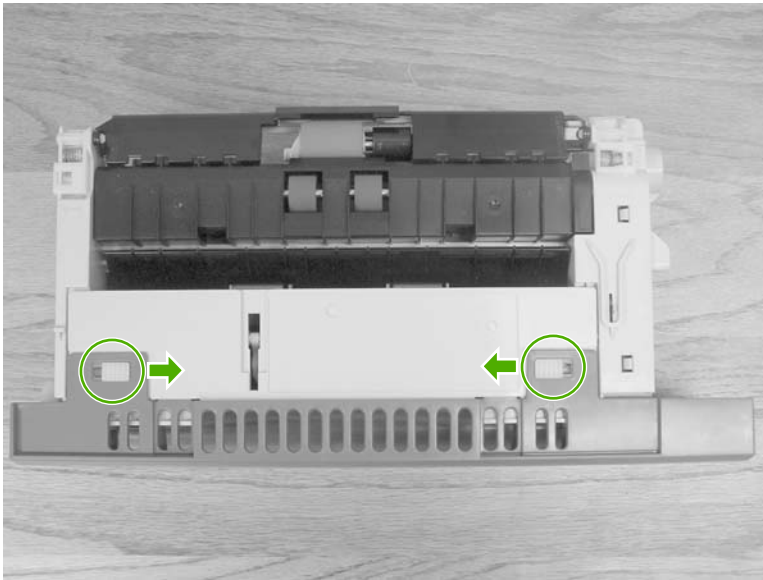

Figure 6-54 Remove the tray 2 separation roller (2 of 3)

4. Close the separation roller cover by sliding the tabs outward before closing the cover.

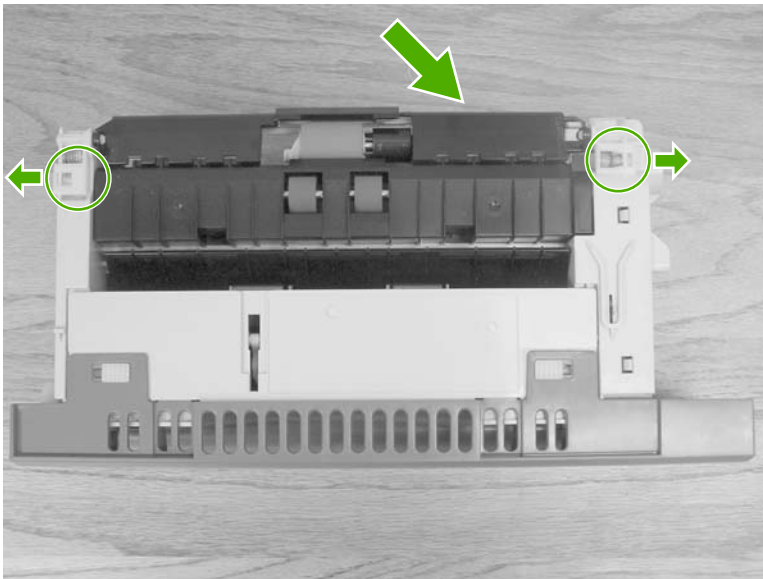

Figure 6-55 Remove the tray 2 separation roller (3 of 3)

Tray 2, 3, or 4 pickup and feed rollers

1. Remove the paper tray. See [Trays 2, 3, and 4 on page 261](#).



Figure 6-46 Remove the tray 2, 3, or 4 pickup and feed rollers (1 of 2)

2. Squeeze the tabs to release the pickup roller (left) and feed roller (right).



Figure 6-47 Remove the tray 2, 3, or 4 pickup and feed rollers (2 of 2)

3. Slide the rollers off the shaft.

Tray 3 or 4 separation rollers

1. Open tray 3 or 4.
2. Open the lower jam access door.

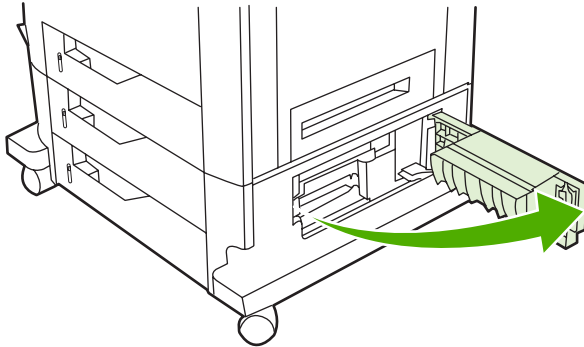

Figure 6-56 Remove the tray 3 or 4 separation rollers (1 of 2)

3. Remove the separation roller by depressing the blue tab and removing the roller from the shaft.

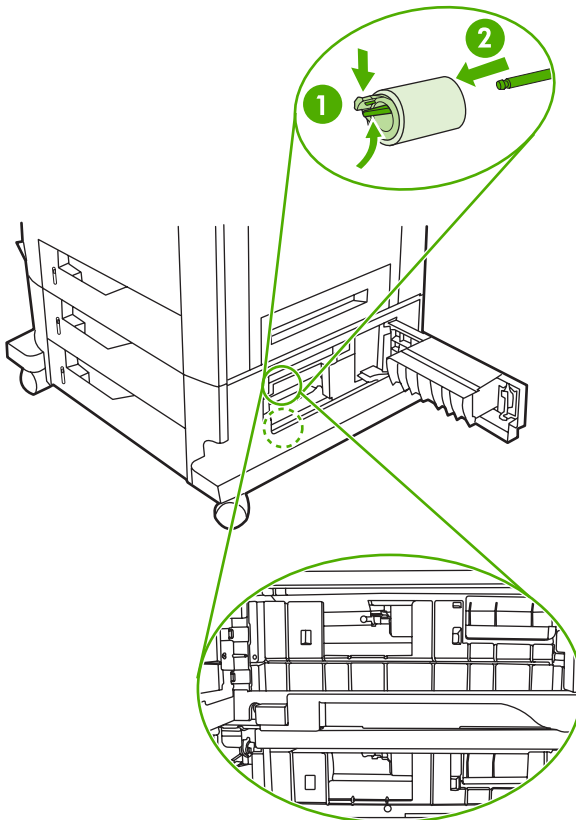

Figure 6-57 Remove the tray 3 or 4 separation rollers (2 of 2)