

3. Pinch together the two large blue tabs on the first cartridge and then lift the cartridge straight up to remove it from the carousel.

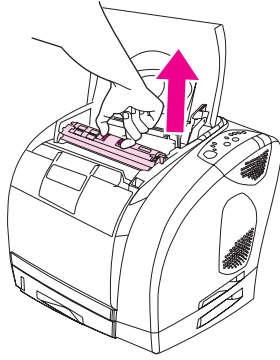

4. Close the top cover, and then press the **Rotate Carousel** button.

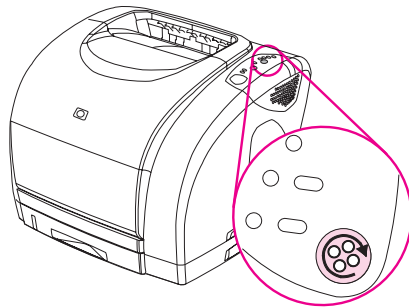

Note

If the print-cartridge carousel does not rotate, see [Functional checks](#).

5. Open the top cover, and then remove the next cartridge following the procedure in step 3.
6. Repeat steps 2 through 5 until all four cartridges have been removed.

Note

When the top door is open, the carousel retracts but does not rotate.

Fuser cover (and fuser)

1. Turn the printer off.
2. Rotate two locking tabs (callout 1) upward.

3. Gently slide the fuser out of the printer.

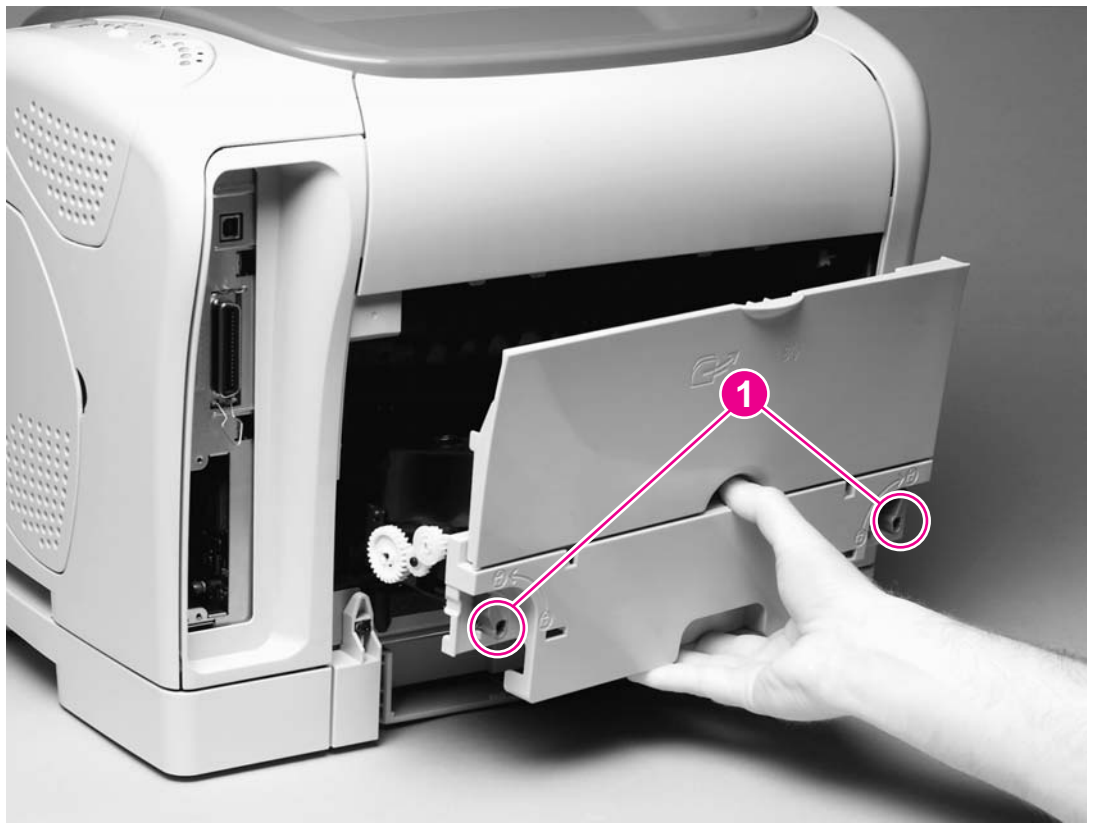
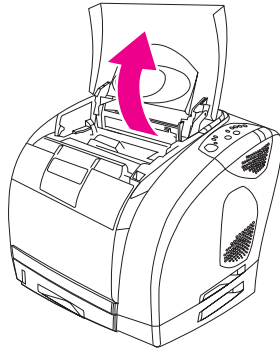

Figure 5-1. Removing the fuser cover (and fuser)

Removal and replacement

Imaging drum

1. Open the top cover.



2. Grasp the imaging drum handle and then rotate the imaging drum until the handle is horizontal.
3. Lift the imaging drum straight up to remove it from the printer.

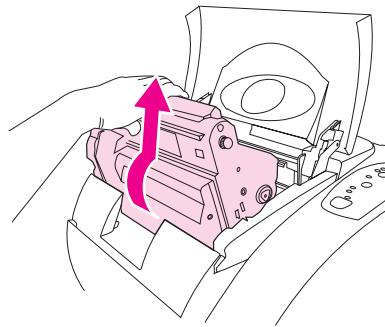

Print cartridges

1. Open the top door.

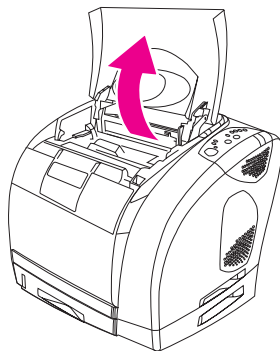

2. Remove the imaging drum (see [Imaging drum](#)).