

Fuser

Before proceeding, remove the following assemblies:

- Duplexer. See [Duplexer on page 9](#).

Remove the fuser

⚠ WARNING! The fuser might be hot.

1. If a finishing accessory is attached, release one handle, and then slide the finishing accessory away from the product.

Figure 1-10 Remove the fuser (1 of 3)

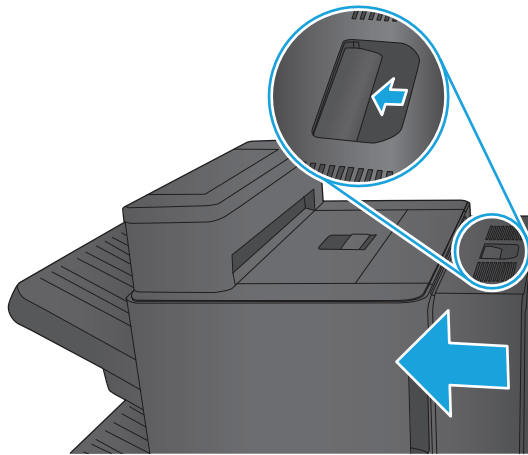

2. Open the left door, release two latches, and then slide the fuser toward the left door.

Figure 1-11 Remove the fuser (2 of 3)

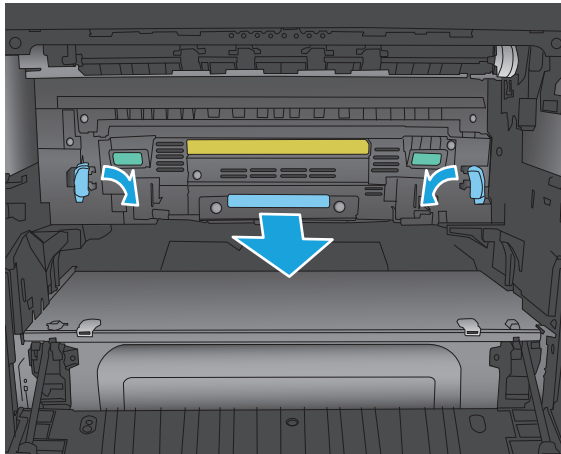

3. Grasp the fuser by the handle, and then lift it out of the product.

Figure 1-12 Remove the fuser (3 of 3)

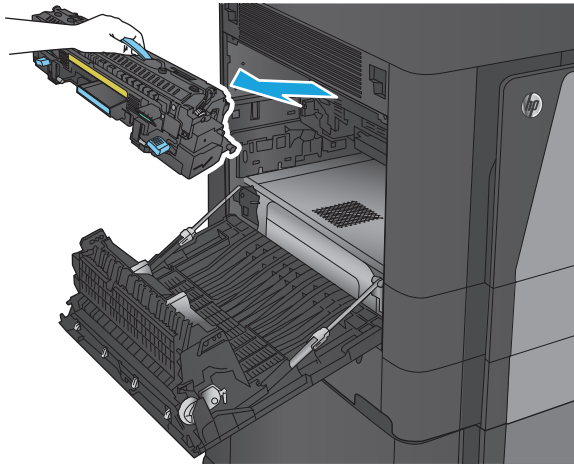

Transfer-roller assembly

1. Open the front cover.
2. Rotate the cartridge release lever down until it clicks into place.

Figure 1-6 Remove the transfer-roller assembly (1 of 2)

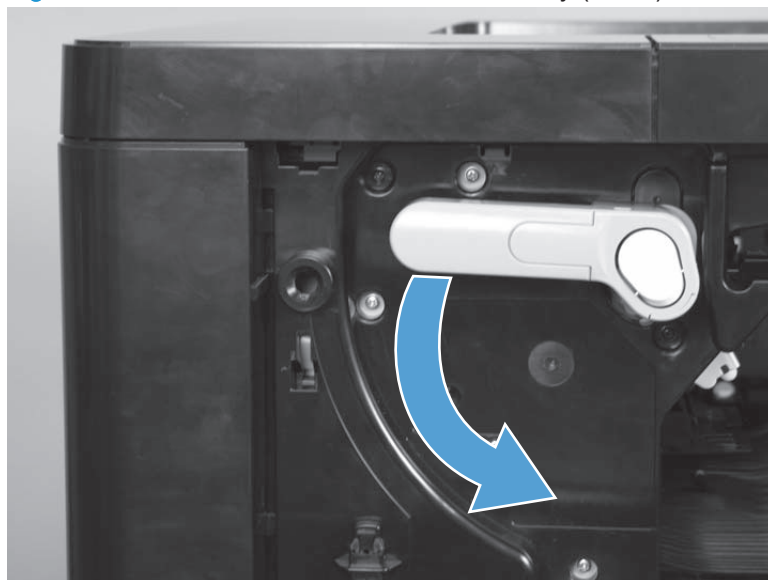

3. Press the blue tab, and then slowly pull the transfer roller assembly toward the front of the product until it stops. Lift the assembly up to release the catch on the underside, and then remove the assembly.



Reinstallation tip Make sure that the transfer roller is completely inserted and latched when it is reinstalled.

Figure 1-7 Remove the transfer-roller assembly (2 of 2)

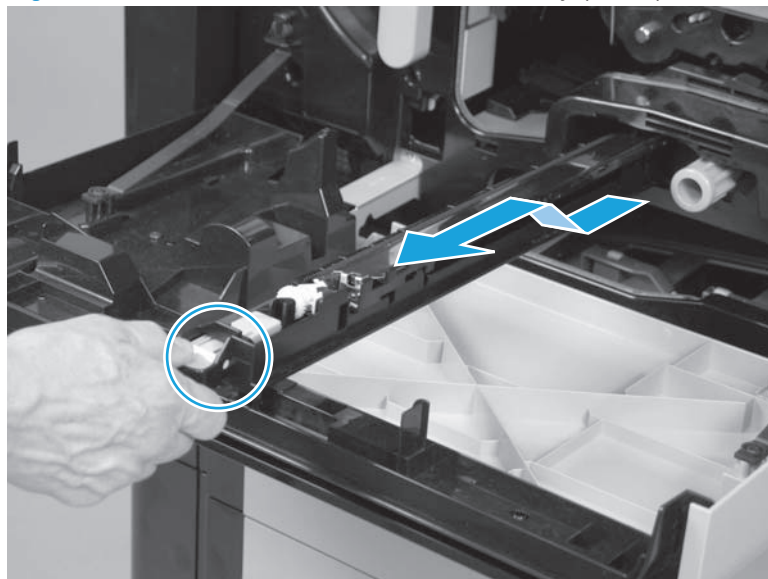

Tray 1 rollers

CAUTION: If you are replacing the rollers, do not touch the surface of the replacement rollers. Skin oils deposited on the rollers might cause paper pickup problems.

1. Open Tray 1.

Figure 1-97 Remove the Tray 1 rollers (1 of 3)

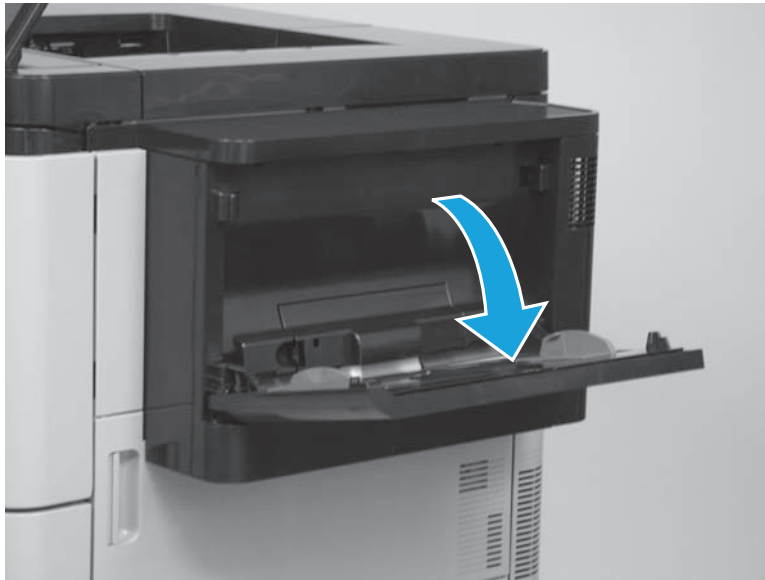

2. Release one tab (callout 1), and then remove the roller cover (callout 2).

Figure 1-98 Remove the Tray 1 rollers (2 of 3)

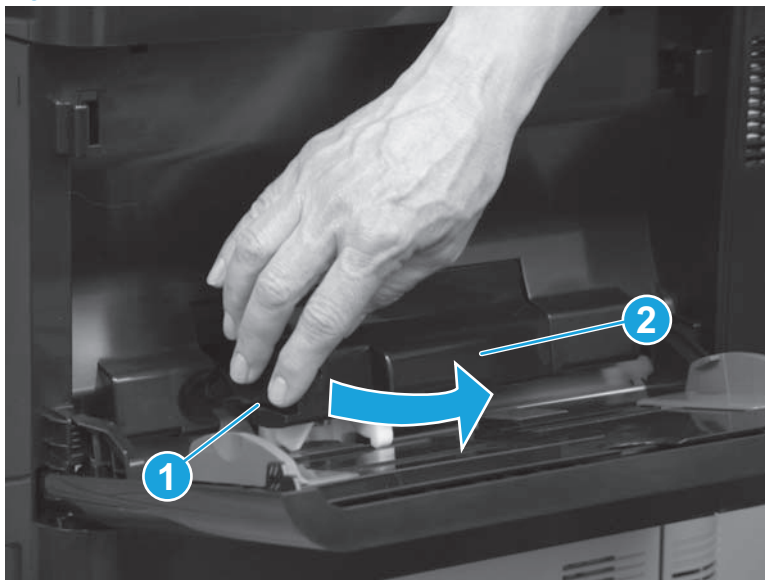

3. Pinch the tabs at the end of the rollers to release them, and then remove three rollers in the order shown below.

Figure 1-99 Remove the Tray 1 rollers (3 of 3)

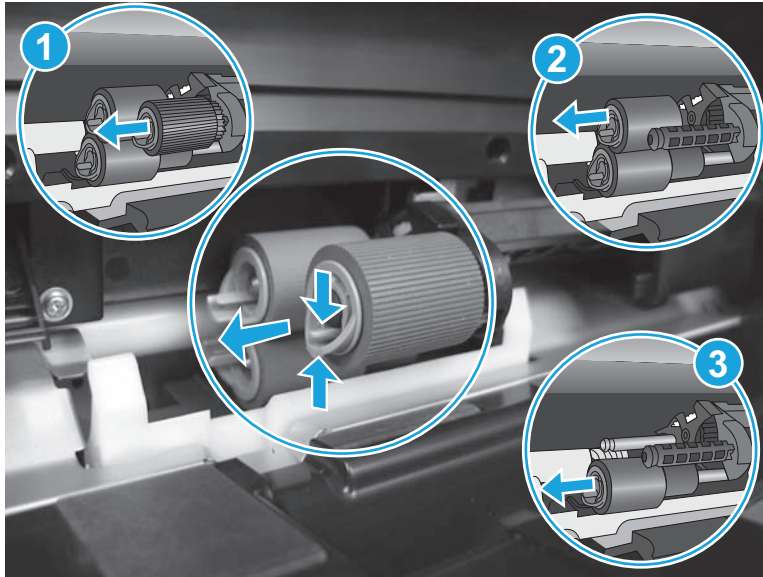

Reinstall the Tray 1 rollers

Reinstall the rollers in the order shown below. Make sure that the rollers snap into place.

Figure 1-100 Reinstall the Tray 1 rollers (1 of 2)

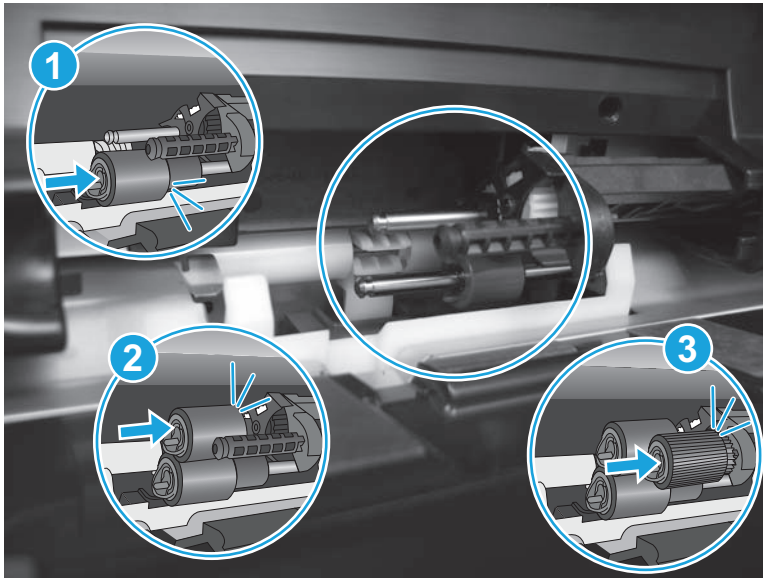

Insert the tab on the right side of the roller cover (callout 1) into the slot on the product (callout 2).

Figure 1-101 Reinstall the Tray 1 rollers (2 of 2)

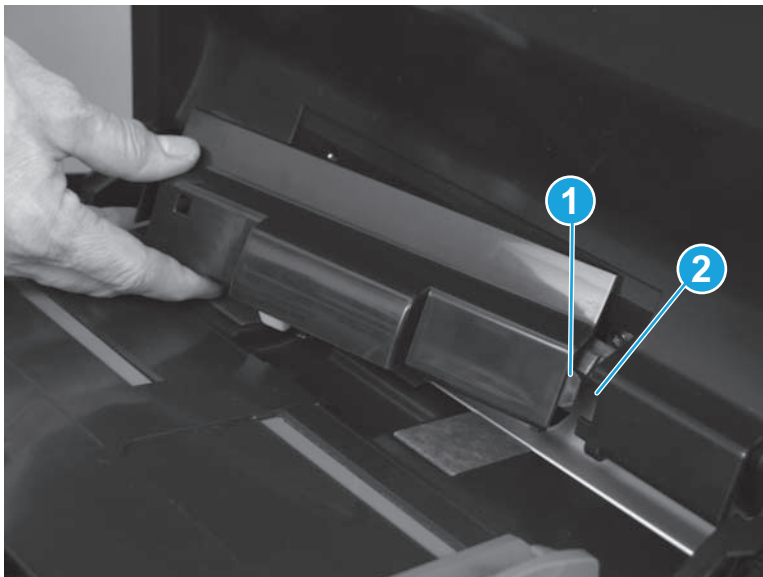

Tray 2 and Tray 3 rollers

⚠ CAUTION: If you are replacing the rollers, do not touch the surface of the replacement rollers. Skin oils deposited on the rollers might cause paper pickup problems.

1. Remove Tray 2 and Tray 3. See [Tray 2 and Tray 3 on page 86](#).
2. Locate the rollers inside the tray cavity.

Figure 1-102 Remove the Tray 2 and Tray 3 rollers (1 of 2)

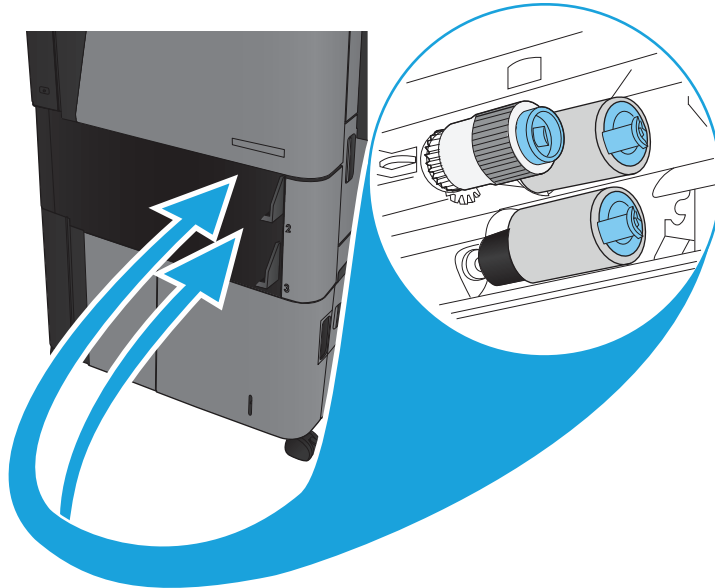

3. Pinch the tabs at the end of the rollers to release them, and then remove three rollers in the order shown below.

Figure 1-103 Remove the Tray 2 and Tray 3 rollers (2 of 2)

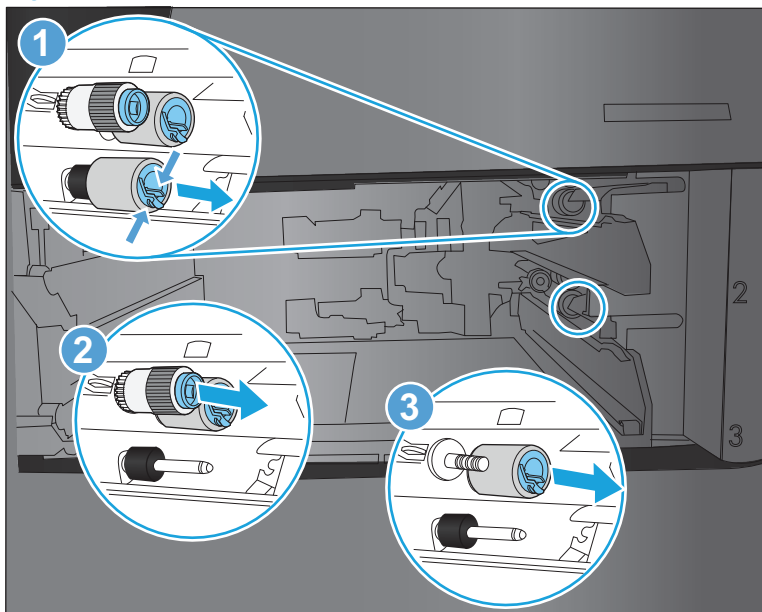

Reinstall the Tray 2 and Tray 3 rollers

Reinstall the rollers in the order shown below. Make sure that the rollers snap into place.

Figure 1-104 Reinstall the Tray 2 and Tray 3 rollers

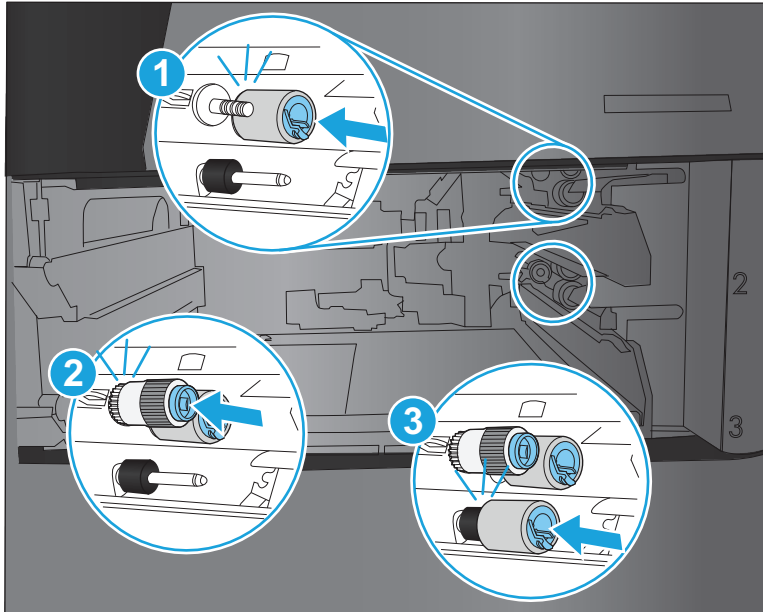

High-capacity input (HCI) rollers

CAUTION: If you are replacing the rollers, do not touch the surface of the replacement rollers. Skin oils deposited on the rollers might cause paper pickup problems.

1. Remove the HCI right tray and the HCI left tray. See [HCI right tray on page 272](#) and [HCI left tray on page 273](#).
2. Locate the rollers inside the tray cavity.

Figure 1-105 Remove the HCI rollers (1 of 2)

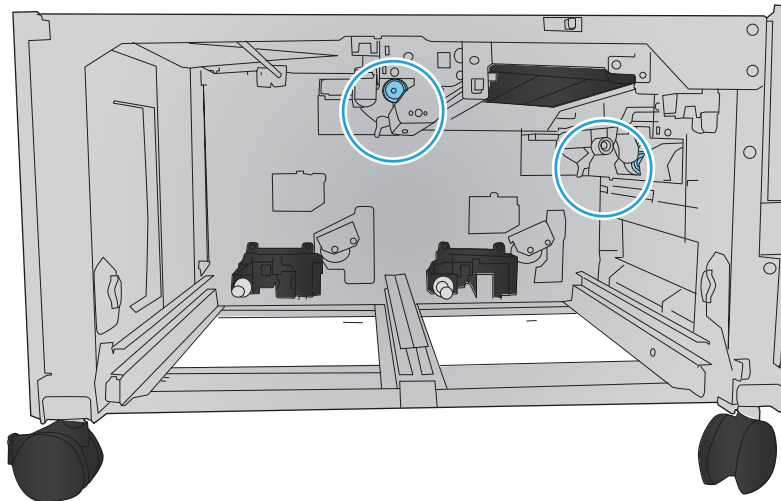

3. Pinch the tabs at the end of the rollers to release them, and then remove two rollers in the order shown below.

NOTE: The uppermost roller is not replaced because it lasts the life of the product.

Figure 1-106 Remove the HCI rollers (2 of 2)

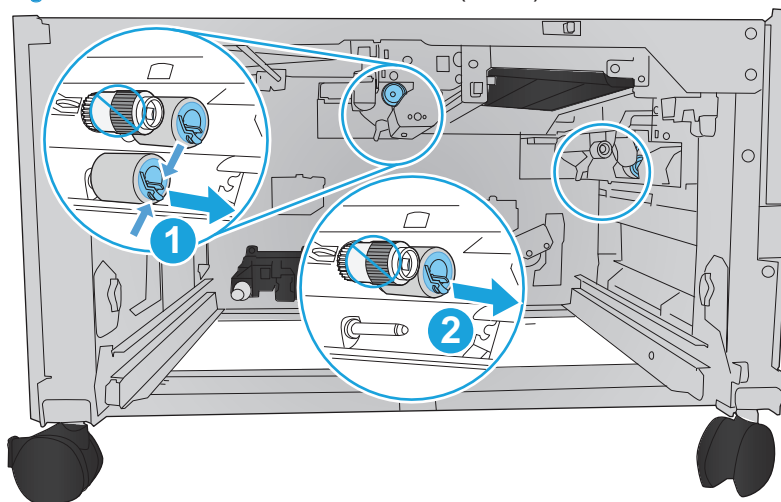

Reinstall the HCI rollers

Reinstall the rollers in the order shown below. Make sure that the rollers snap into place.

Figure 1-107 Reinstall the HCI rollers

