

Automatic document-feeder (ADF)

Automatic document feeder (ADF) assemblies

Figure 9-73 ADF unit

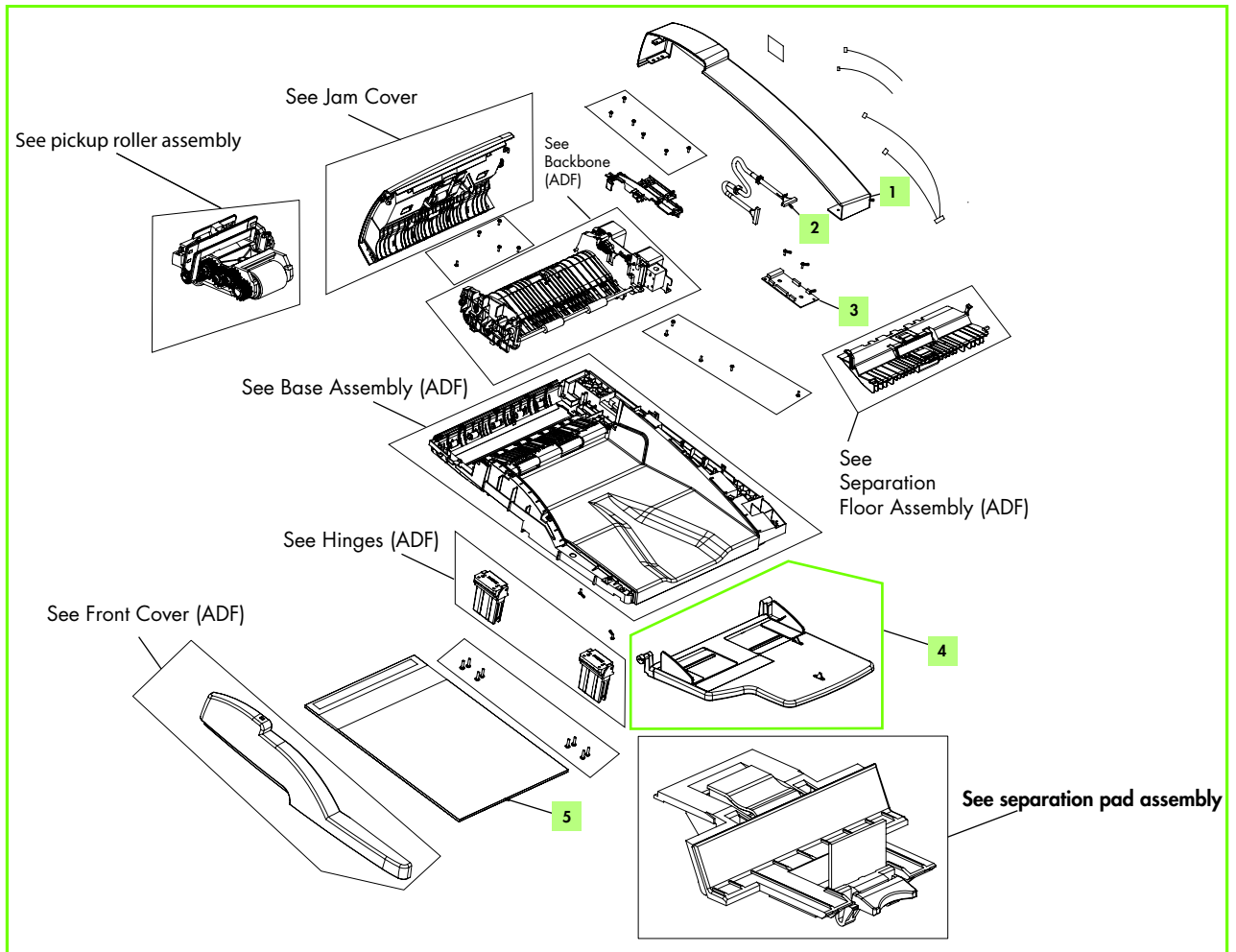

Table 9-61 ADF unit

| Ref | Description | Part number | Qty |
|-----------|--|-------------|-----|
| All | Automatic document feeder (ADF) whole unit | Q3938-67943 | 1 |
| 1 | End cover (cap) back | Q3938-67945 | 1 |
| 2 | Cable, ADF to scanner | Q3938-67948 | 1 |
| 3 | PCA motor assembly | Q7829-67903 | 1 |
| 4 | Tray-input assembly | Q3938-67950 | 1 |
| 5 | Reflector foam (white backing) | Q7829-67909 | 1 |
| Not shown | Flag sensor LS | Q3938-67951 | 1 |
| Not shown | Photo interrupter with connector | Q7829-67914 | 1 |
| Not shown | Maintenance kit | Q3938-67944 | 1 |



NOTE: Only highlighted parts are orderable.