

Figure 9-48 Output bin 2 (stack lower-tray assembly) (1 of 2) (stapler/stacker and booklet-maker)

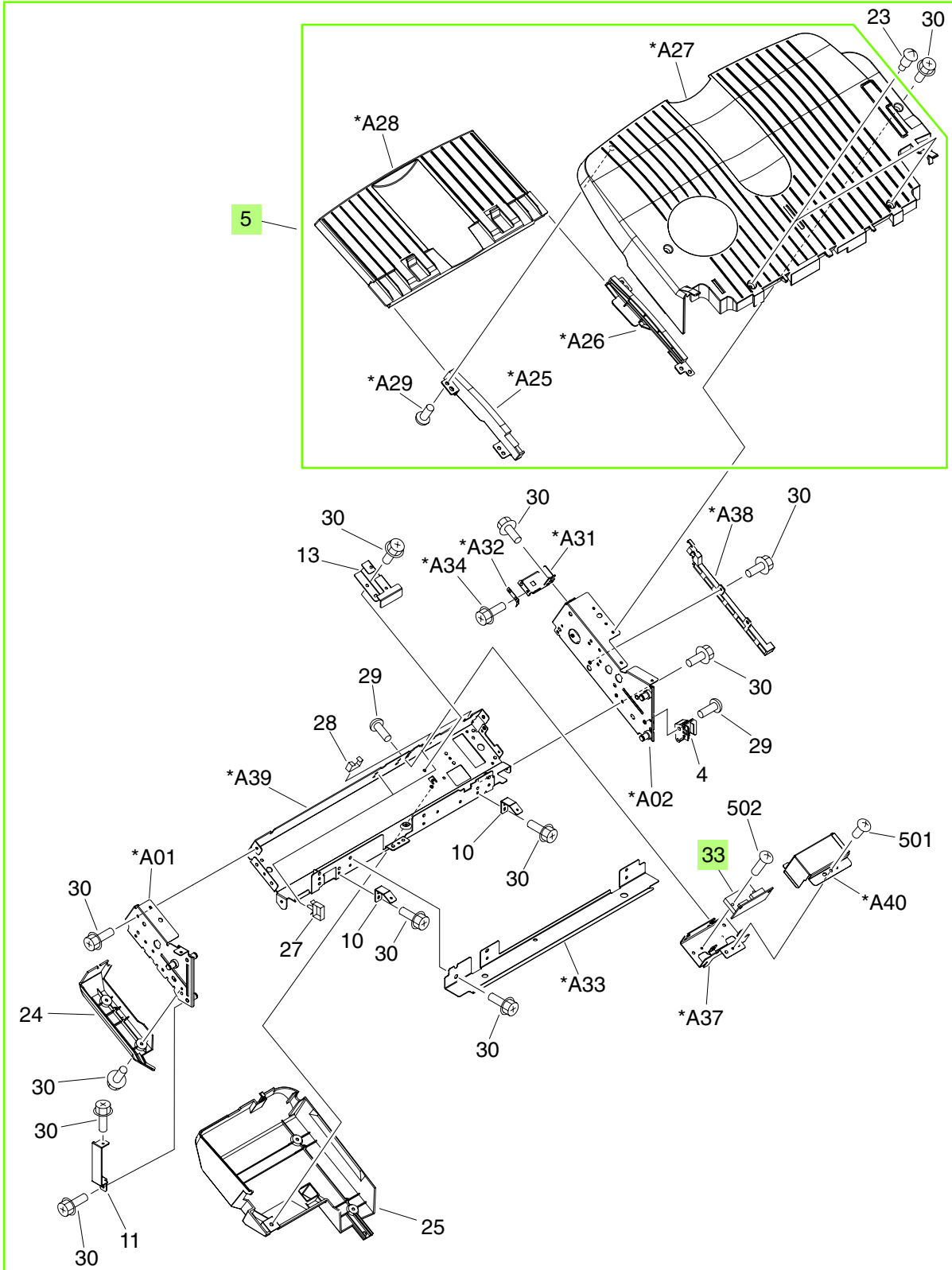

Figure 9-49 Output bin 2 (stack lower-tray assembly) (2 of 2) (stapler/stacker and booklet-maker)

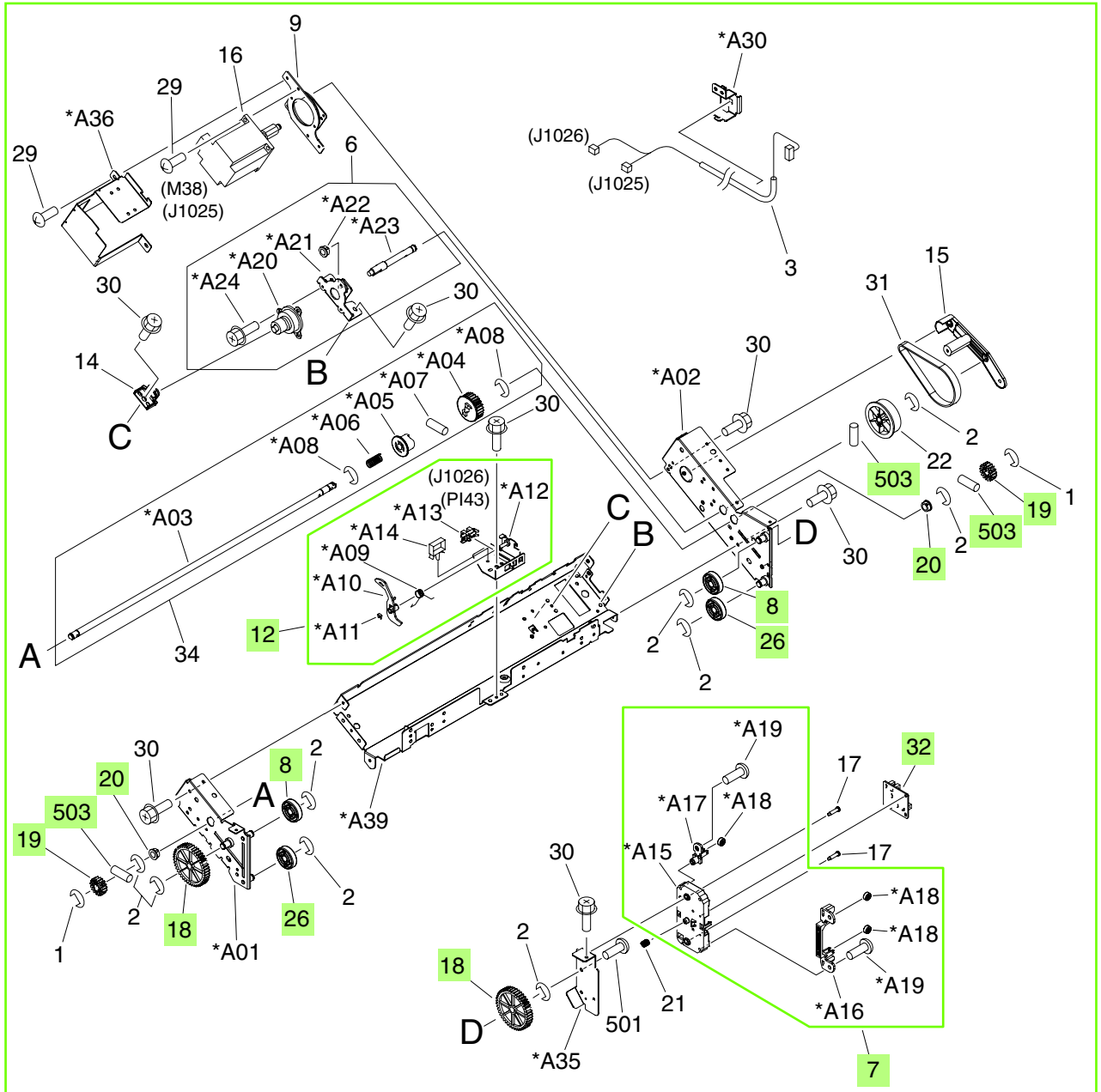



Table 9-41 Output bin 2 (stack lower-tray assembly) (stapler/stacker and booklet-maker)

Ref	Description	Part number	Qty
All	Stack lower-tray assembly	RM1-4105-000CN	1
5	Stack-tray assembly	RM1-4104-000CN	1
7	Area-sensor holder assembly	FM2-0709-000CN	1
8	Roller, tray-guide	FC5-4221-000CN	2
12	Paper-sensor assembly	FM2-0707-000CN	1
18	Gear, 44T	FU5-0435-000CN	2
19	Gear, 17T	FU5-0457-000CN	2
20	Bushing	FU5-1169-000CN	2
26	Roller, tray-guide	RU5-6035-000CN	2
32	Area-sensor PCA assembly	4G1-1498-000CN	1
33	Tray-driver PCA assembly	FG3-2887-000CN	1
503	Pin, dowel	XD3-2300-142CN	3

 **NOTE:** Only highlighted parts are orderable.