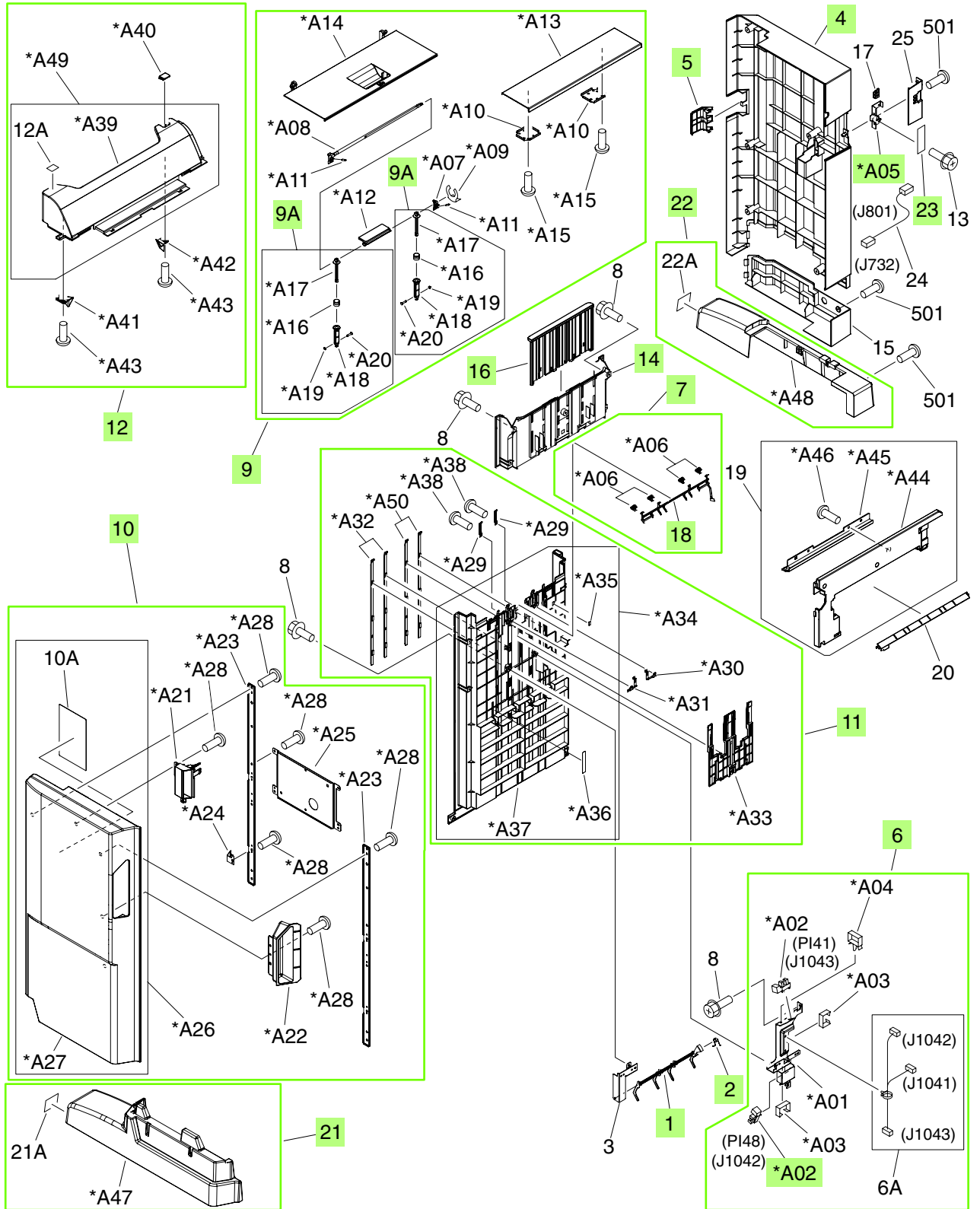



**Figure 9-37** External panels and covers (stapler/stacker)



**Table 9-36 External panels and covers (stapler/stacker)**

| Ref | Description                     | Part number    | Qty |
|-----|---------------------------------|----------------|-----|
| 1   | Flag, paper-sensing sensor      | FC5-5004-000CN | 1   |
| 2   | Spring, torsion                 | FC5-5005-000CN | 1   |
| 4   | Cover, rear                     | RC2-1278-000CN | 1   |
| 5   | Cover, tray-connector           | RC2-1279-000CN | 1   |
| 6   | Paper-face sensor assembly      | 4G3-0934-000CN | 1   |
| 7   | Paper-face sensing assembly     | 4G3-1624-000CN | 1   |
| 9   | Top-door (upper-cover) assembly | RM1-4121-000CN | 1   |
| 9A  | Link-slide assembly             | 4G3-0271-000CN | 2   |
| 10  | Front-door assembly             | RM1-4134-000CN | 1   |
| 11  | Lower height-guide assembly     | RM1-4135-000CN | 1   |
| 12  | Left upper-cover assembly       | RM1-4179-000CN | 1   |
| 14  | Panel, height, upper            | RC2-1283-000CN | 1   |
| 16  | Cover, option-slide             | RC2-1347-000CN | 1   |
| 18  | Flag, paper-face sensing, upper | FC5-4162-000CN | 1   |
| 21  | Cover, front-lower              | RL1-1717-000CN | 1   |
| 22  | Cover, rear-lower               | RL1-1718-000CN | 1   |
| 23  | LED-PCA assembly                | RM1-4141-000CN | 1   |
| A02 | Photo interrupter, TLP1242      | WG8-5593-000CN | 2   |
| A05 | Mount, LED-PCA                  | RC2-1735-000CN | 1   |

 **NOTE:** Only highlighted parts are orderable.