

Internal components (5 of 5)

Figure 8-7 Internal components 5 of 5

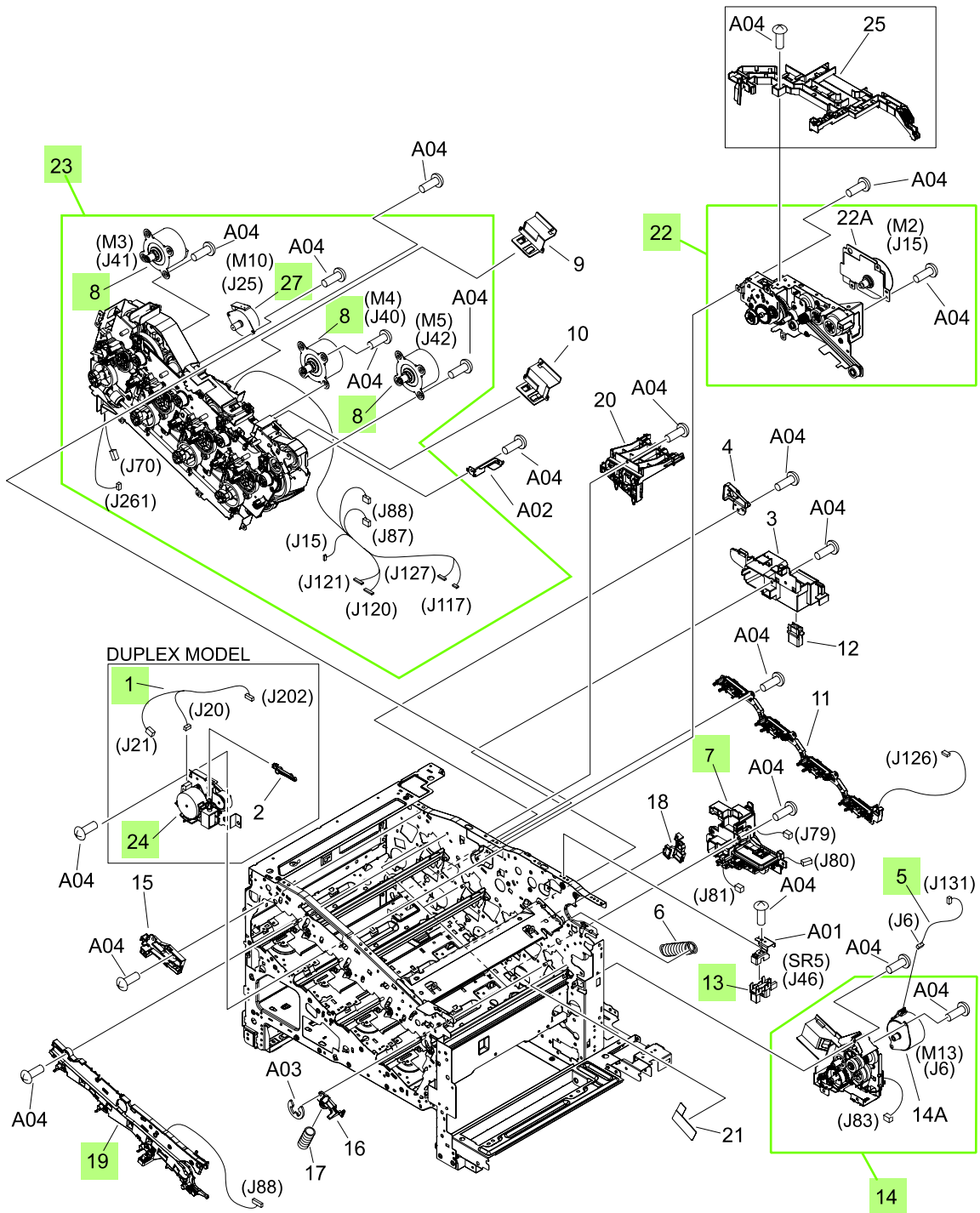

Table 8-8 Internal components (5 of 5)

Ref	Description	Part number	Qty
1	Duplexing unit cable assembly	RM1-5730-000CN	1
5	Pick up motor cable assembly	RM1-5731-000CN	1
7	Lifter drive assembly	RM1-4976-000CN	1
8	Drum motor assembly	RM1-4988-000CN	3
13	Photo interrupter, TLP1243	WG8-5696-000CN	1
14	Cassette paper pick up drive assembly with motor	RM1-4975-000CN	1
19	Rear Pre-exposure PCA assembly	RM1-5705-000CN	1
22	Fusing (fixing) drive assembly with motor (duplex)	RM1-4974-000CN	1
22	Fusing (fixing) drive assembly with motor (simplex)	RM1-5001-000CN	1
23	Main drive assembly kit	CC468-67918	1
24	Duplexing drive assembly	RM1-4973-000CN	1
27	Stepping motor, DC (developing disengagement)	RK2-2415-000CN	1