

Internal components (2 of 6)

Figure 4-4 Internal components (2 of 6)

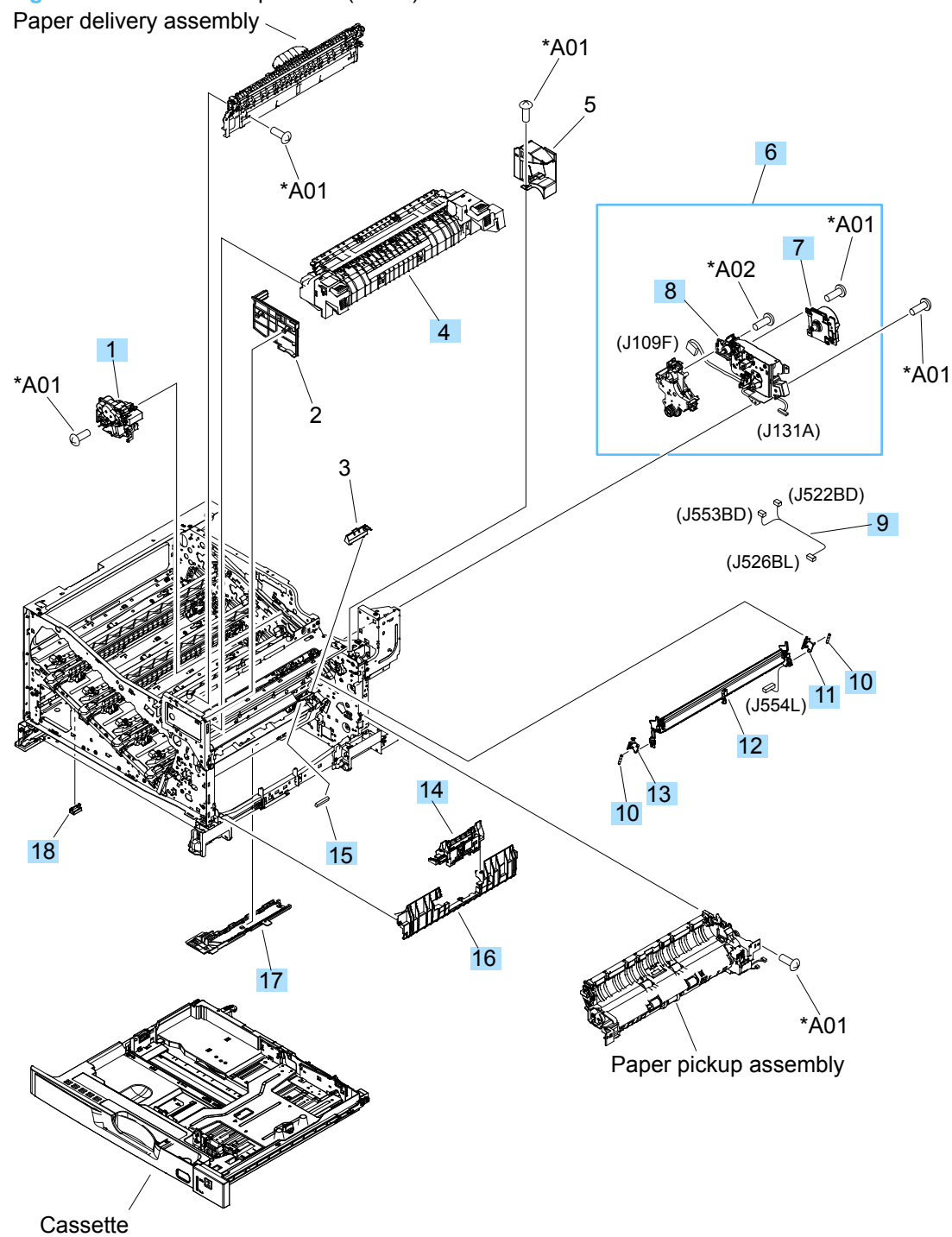

Table 4-8 Internal components (2 of 6)

Ref	Description	Part number	Qty
1	Drive assembly, duplex reverse (duplex model only)	RM1-6167-000CN	1
1	Drive assembly, simplex model	RM1-6121-000CN	1
4	Fuser assembly, 110V (included in service kit)	CE710-69001	1
4	Fuser assembly, 220V (included in service kit)	CD710-69002	1
6	Fuser drive assembly	RM1-6076-000CN	1
7	Fuser motor assembly	RM1-6075-000CN	1
8	Gear assembly, fuser	RM1-7914-000CN	1
9	Cable, SV joint, low-voltage power supply	RM1-6868-000CN	1
10	Spring, tension, registration sensor	RU6-2710-000CN	2
11	Support, frame, rear	RC2-7197-000CN	1
12	Registration sensor assembly	RM1-6002-000CN	1
13	Support, frame, front	RC2-7196-000CN	1
14	Separation roller assembly (included in service kit)	CE710-69007	1
15	Connector, snap tight, black	VS1-7207-019CN	1
16	Guide, paper feed	RC2-7297-000CN	1
17	Sensor, cassette last paper presence	RM1-6164-000CN	1
18	Cover, connector, lower	RC2-6642-000CN	1