

Figure 9-21 Printer duplexing-reverse assembly (duplex model)

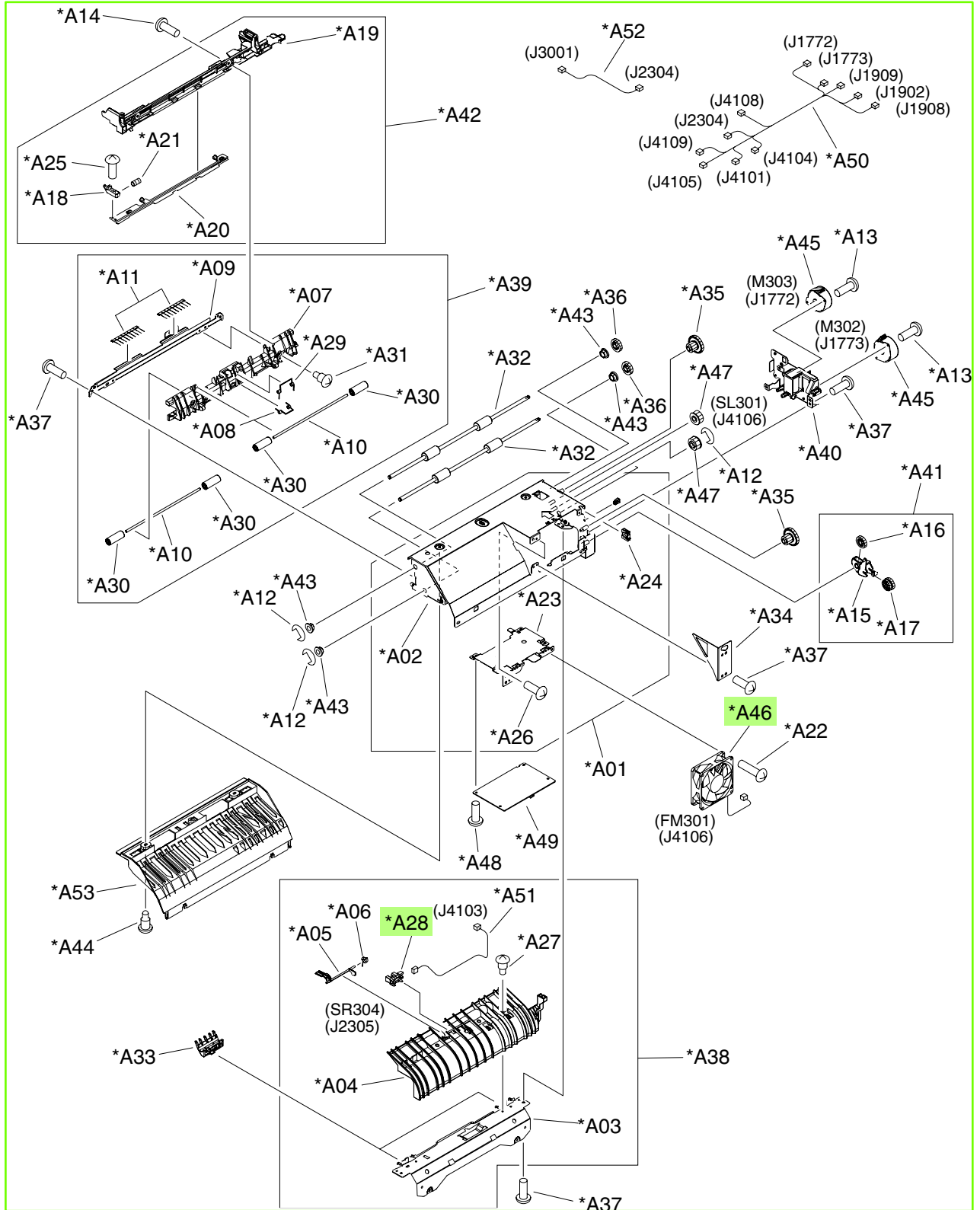



Table 9-19 Printer duplexing-reverse assembly

Ref	Description	Part number	Qty
All	Duplexing-reverse assembly	RM1-3652-000CN	1
A28	Photo interrupter, TLP1243	WG8-5696-000CN	1
A46	Fan	RK2-1378-000CN	1

 **NOTE:** Only highlighted parts are orderable.