

Figure 9-5 Printer right-door assembly

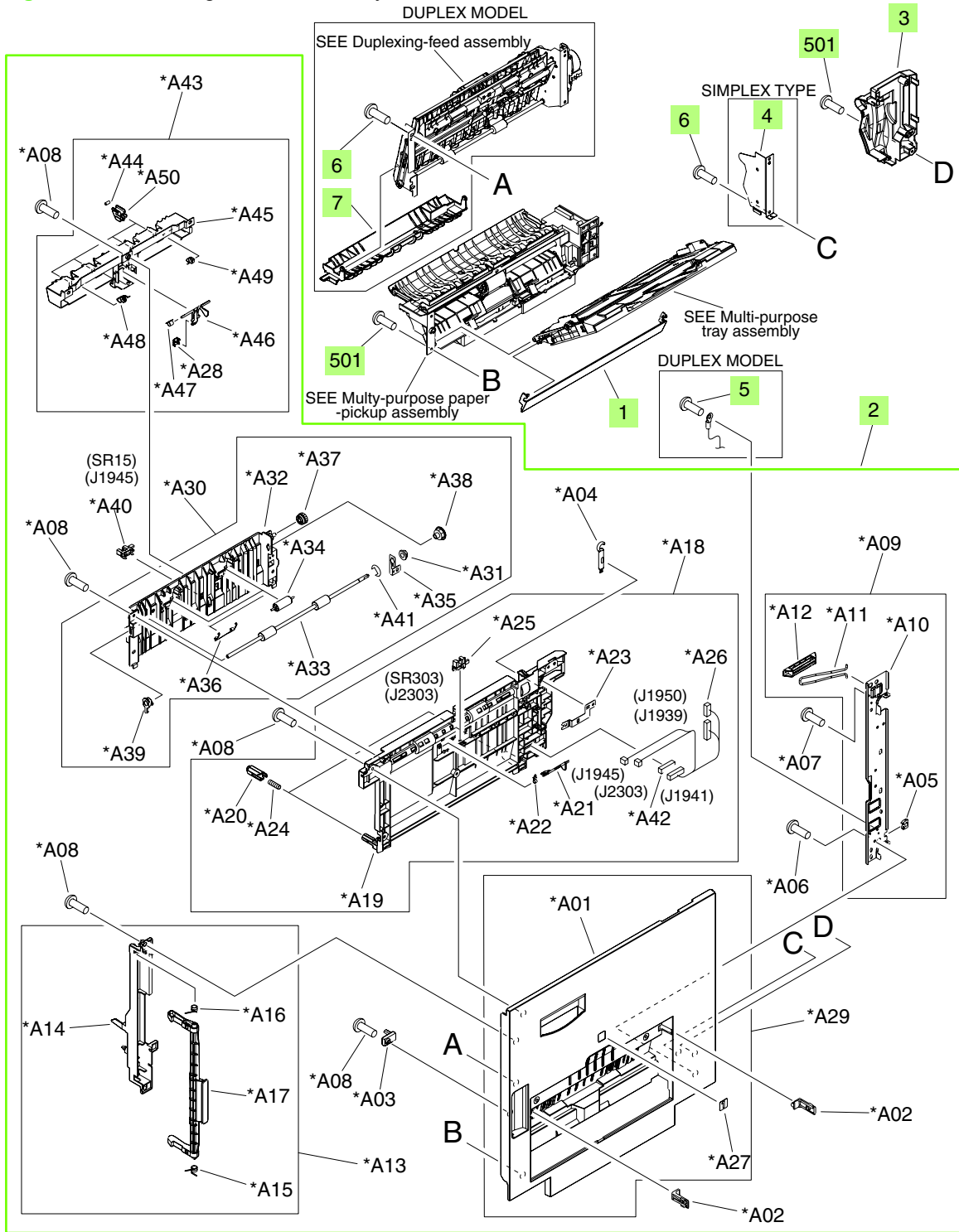



Table 9-3 Printer right-door assembly

Ref	Description	Part number	Qty
1	Cover, multi-purpose blanking	RC1-8527-000CN	1
2	Right-door sub-assembly	RM1-3333-000CN	1
3	Cover, motor	RC1-9511-000CN	1
4	Support, door-cover (simplex)	RC1-9014-000CN	1
5	Screw, RS, M3X6 (duplex)	XA9-1495-000CN	1
6	Screw, with washer, M4X12	XA9-1422-000CN	2 (simplex)
6	Screw, with washer, M4X12	XA9-1422-000CN	4 (duplex)
7	Guide, duplexing-feed, upper (duplex)	RL1-1335-000CN	1
501	Screw, tapping, truss-head, M4X10	XB4-7401-005CN	7

 **NOTE:** Only highlighted parts are orderable.