

Table 9-39 Top output bin (stack sub-tray assembly) (stapler/stacker)

Ref	Description	Part number	Qty
All	Stack sub-tray assembly	RM1-4115-000CN	1

 **NOTE:** Only highlighted parts are orderable.

Figure 9-52 Operation-tray assembly (1 of 2) (stapler/stacker and booklet-maker)

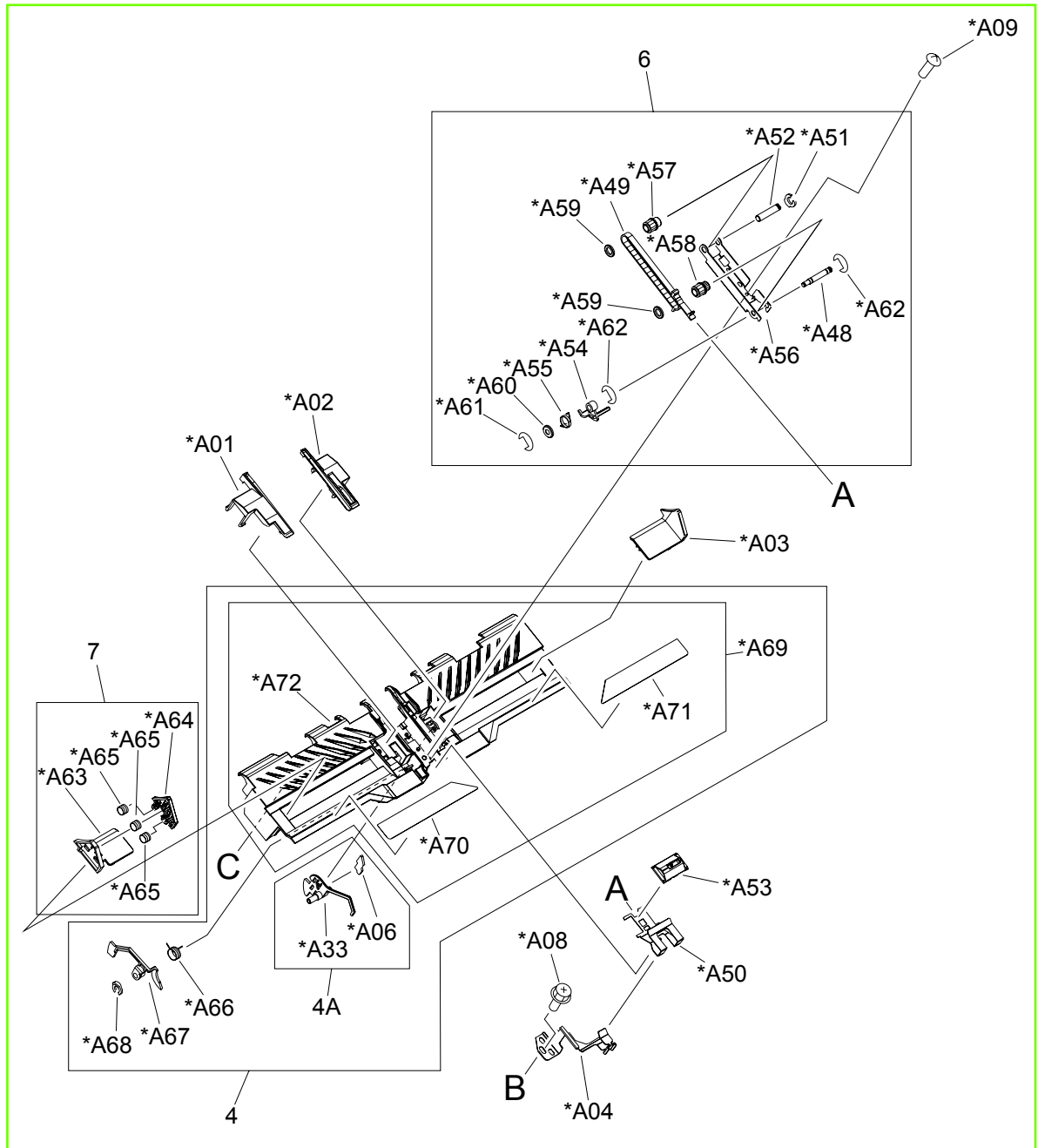

Figure 9-53 Operation-tray assembly (2 of 2) (stapler/stacker and booklet-maker)

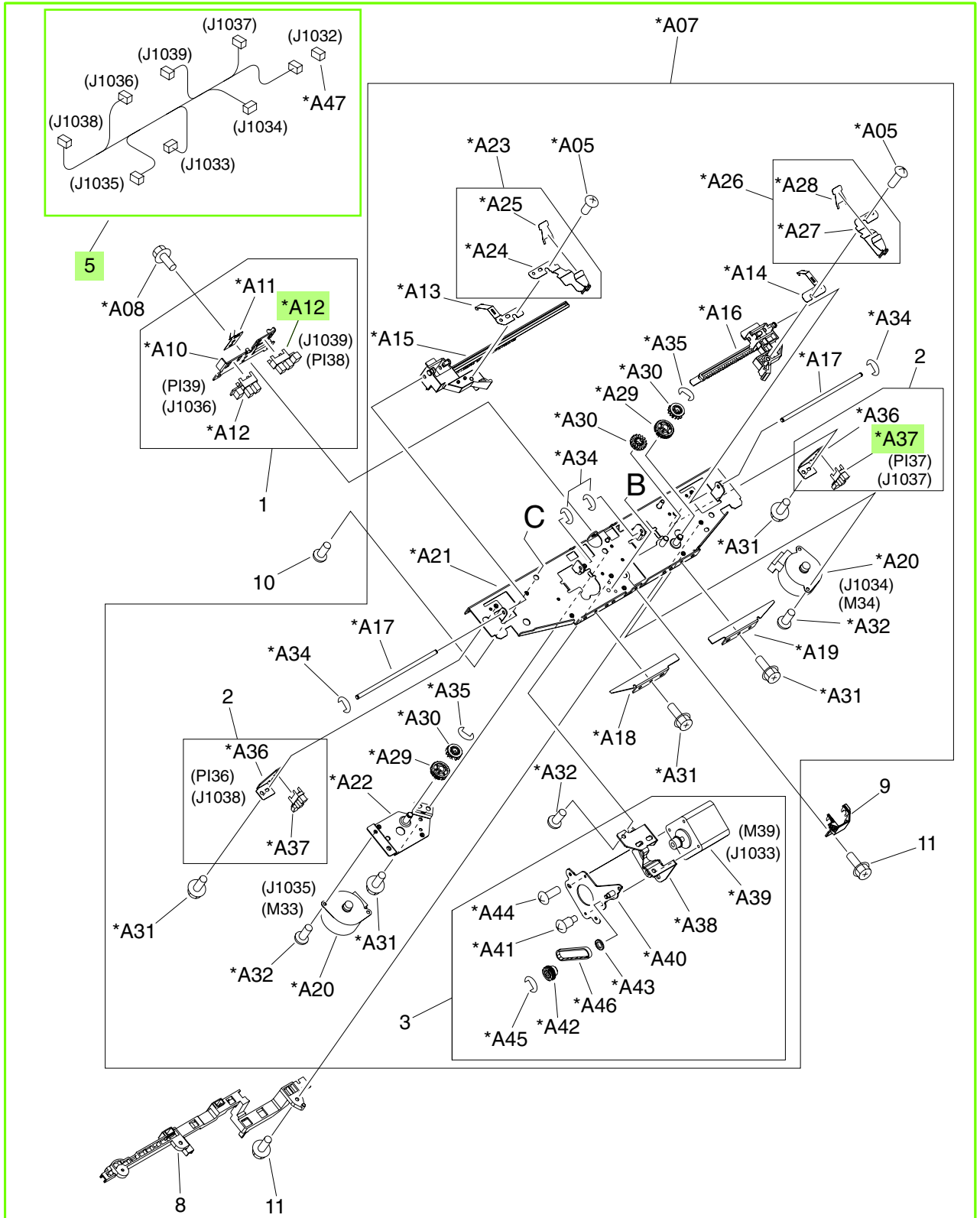



Table 9-40 Operation-tray assembly (stapler/stacker and booklet-maker)

Ref	Description	Part number	Qty
All	Operation-tray assembly	RM1-4125-000CN	1
5	Cable, operation-tray	FG3-2903-000CN	1
A12	Photo interrupter, TLP1242	WG8-5593-000CN	2
A37	Photo interrupter, TLP1242	WG8-5593-000CN	1

 **NOTE:** Only highlighted parts are orderable.