

Internal components (8 of 9)

Figure 4-10 Internal components (8 of 9)

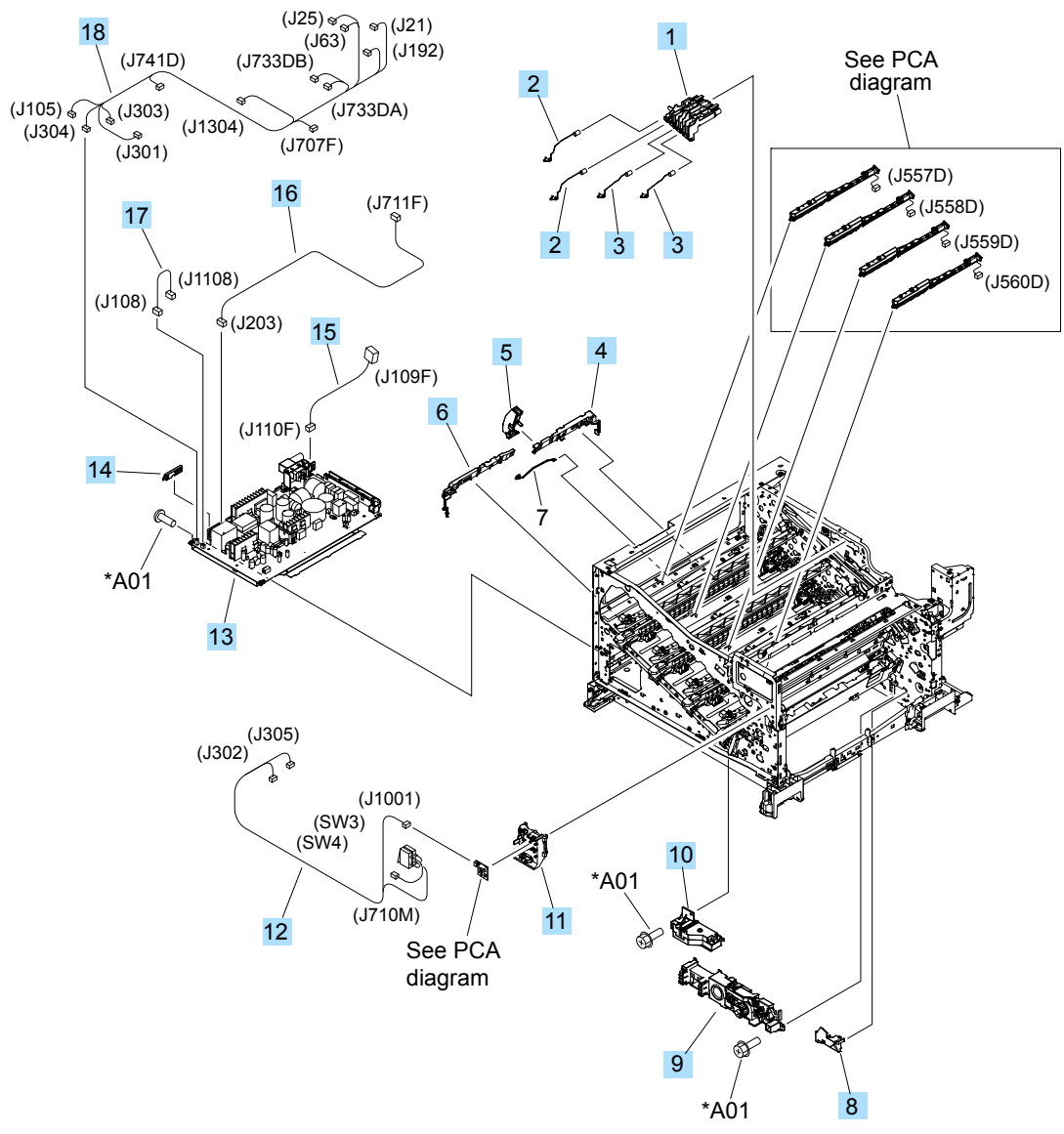

Table 4-14 Internal components (8 of 9)

Ref	Description	Part number	Qty
1	Holder, first power dispatching	RC2-6680-000CN	1
2	Spring, contact	RU6-2767-000CN	2
3	Spring, contact	RU6-2768-000CN	2
4	Guide, cross-member cable, rear	RC2-6588-000CN	1
5	Stopper, laser	RC2-6646-000CN	1
6	Guide, cross-member cable, front	RC2-6587-000CN	1
7	Spring, rod	RC2-6611-000CN	1
8	Cover, cable, right rear	RC2-8424-000CN	1
9	Lifter drive assembly	RM1-6039-000CN	1
10	Auto close assembly	RM1-6036-000CN	1
11	Holder, switch	RC2-6666-000CN	1
12	Cable, switch	RM1-6830-000CN	1
13	Low voltage power supply assembly, 110V	RM1-6753-000CN	1
13	Low voltage power supply assembly, 220V	RM1-6754-000CN	1
14	Guide, cable	RC3-0684-000CN	1
15	Cable, low-voltage AC joint	RM1-6811-000CN	1
16	Cable, low-voltage power supply	RM1-6807-000CN	1
17	Cable, low-voltage power supply, test	RM1-6813-000CN	1
18	Cable, left, high-voltage power supply to low-voltage power supply	RM1-6833-000CN	1