

# Internal assemblies

## Internal assemblies (1 of 5)

Figure 4-3 Internal assemblies (1 of 5)

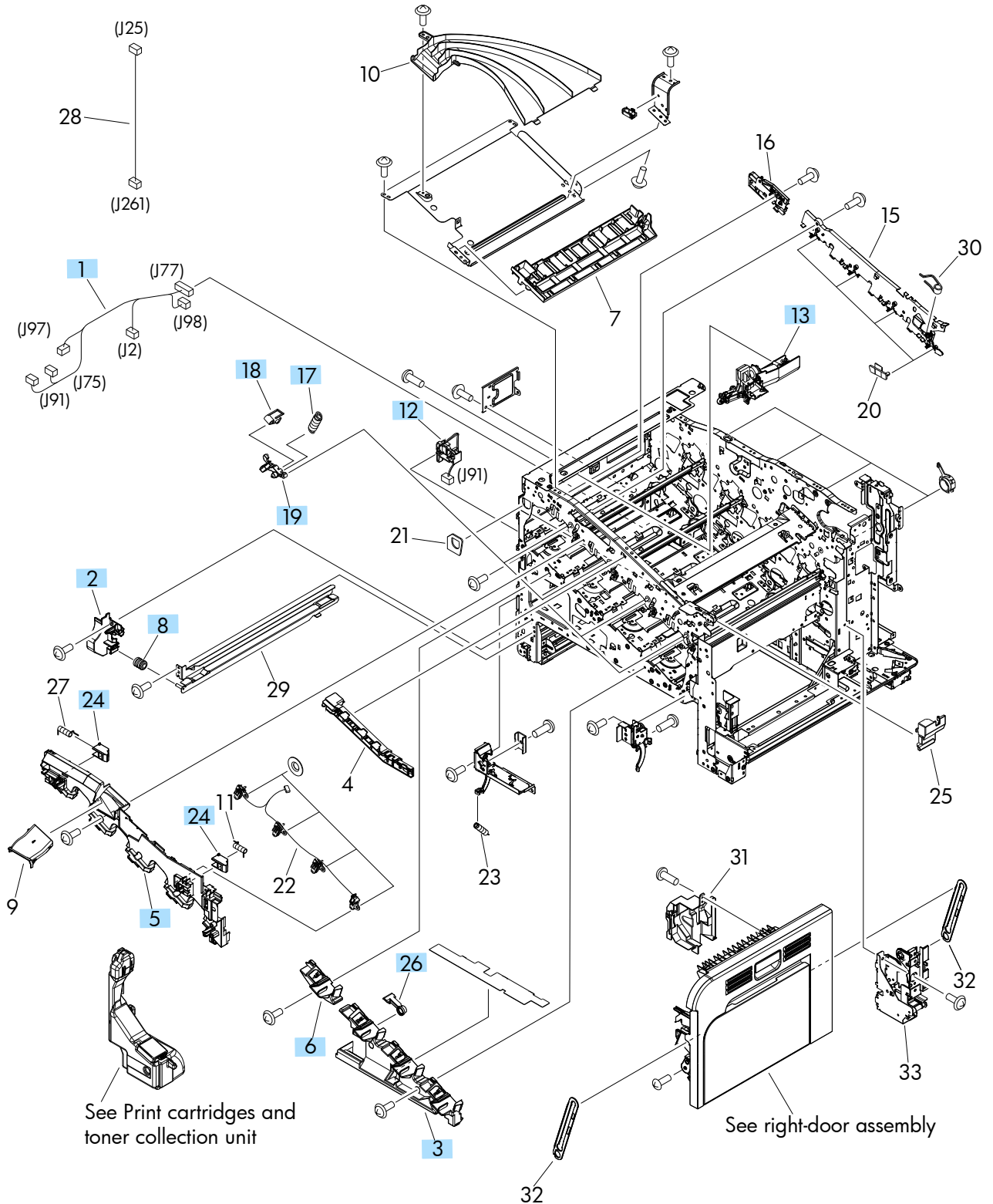

**Table 4-4 Internal assemblies (1 of 5)**

<b>Ref</b>	<b>Description</b>	<b>Part number</b>	<b>Qty</b>
1	Left cable assembly	RM1-5742-000CN	1
2	Holder, CST positioning	RC3-1231-000CN	1
3	Cover, front inner lower unit (CMK)	RL1-1914-020CN	1
5	Cover, front inner, upper	RC3-1070-000CN	1
6	Cover, front inner lower (Y)	RL1-1915-000CN	1
8	Roller, rail	RC2-4831-000CN	1
12	Waste toner detect assembly	RM1-5696-000CN	1
13	Waste toner duct assembly	RM1-8138-000CN	1
17	Spring, tension	RU7-2192-000CN	4
18	Spring, ground	RU6-2237-000CN	4
19	Lever, cartridge pressure front	RC2-3983-030CN	4
24	Lock, door	RC2-5937-000CN	2
26	Lever, box presence detect	RC2-5951-000CN	1