

Internal assemblies (3 of 5)

Figure 4-5 Internal assemblies (3 of 5)

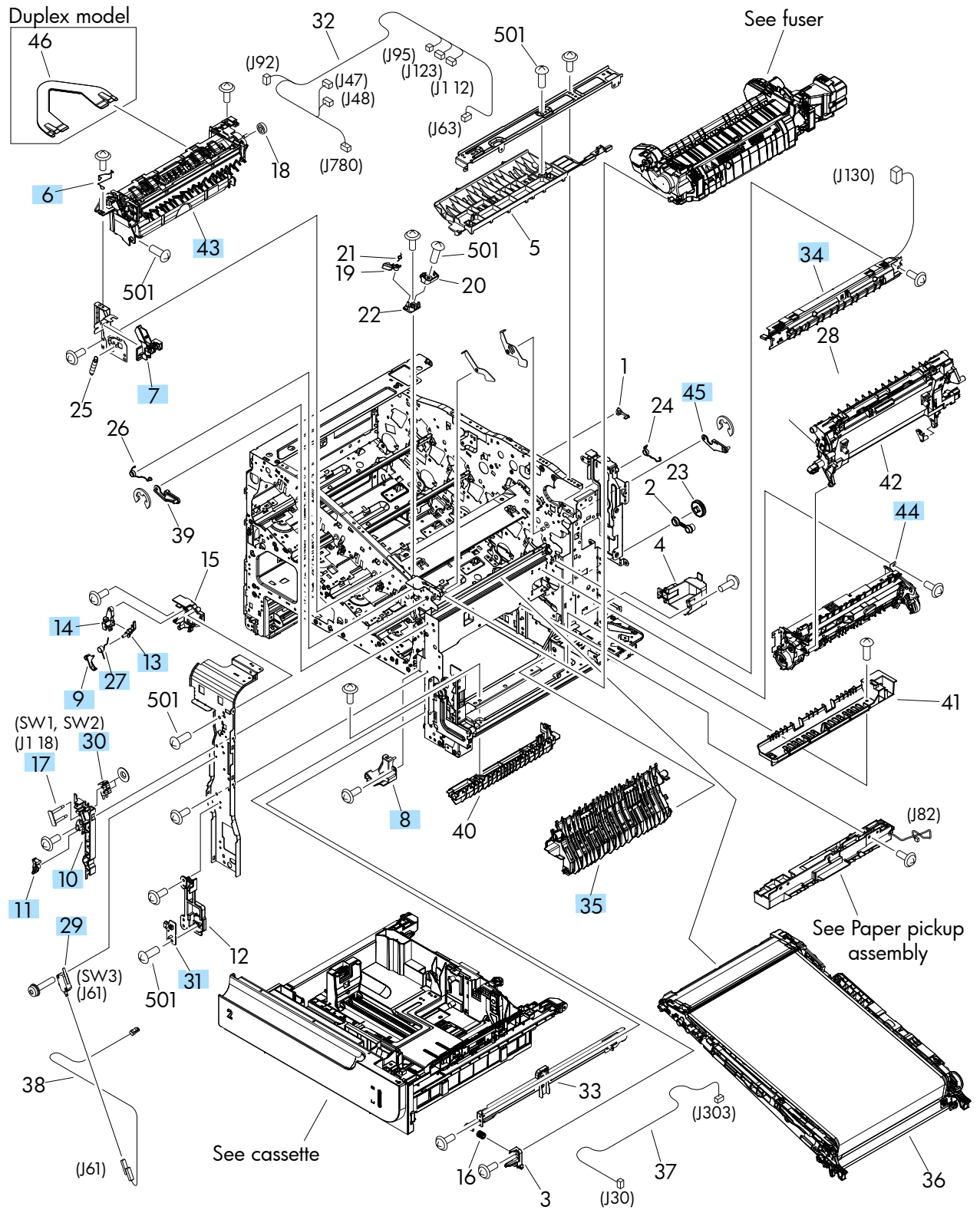

Table 4-6 Internal assemblies (3 of 5)

Ref	Description	Part number	Qty
6	Wire, (mech) sensor protect	RC2-4828-000CN	1
7	Sensor cable guide assembly	RM1-8178-000CN	1
8	Cover, right lower inner	RC2-5019-000CN	1
9	Link, interlock	RC2-5120-000CN	1
10	Mount, interlock switch	RC2-5123-000CN	1
11	Arm, interlock link switch	RC2-5121-000CN	1
13	Link, interlock	RC2-5119-000CN	1
14	Link, interlock	RC2-5118-000CN	1
17	Shaft	RC2-5913-000CN	1
27	Link, interlock	RC2-5122-000CN	1
29	Microswitch	WC4-5171-000CN	1
30	Door switch assembly	RM1-5732-000CN	1
31	Switch, PCA assembly	RM1-8097-000CN	1
34	Density detect assembly	RM1-8163-000CN	1
35	Pick up lower guide assembly	RM1-8132-000CN	1
43	Paper delivery assembly (simplex)	RM1-5003-050CN	1
43	Paper delivery assembly (duplex)	RM1-4970-060CN	1
44	Registration assembly (simplex)	RM1-5009-000CN	1
44	Registration assembly (duplex)	RM1-4969-000CN	1
45	Rear lock arm assembly	RM1-5533-000CN	1