

Stapling mailbox assemblies (1 of 2)

Figure 2-25 Stapling mailbox assemblies (1 of 2)

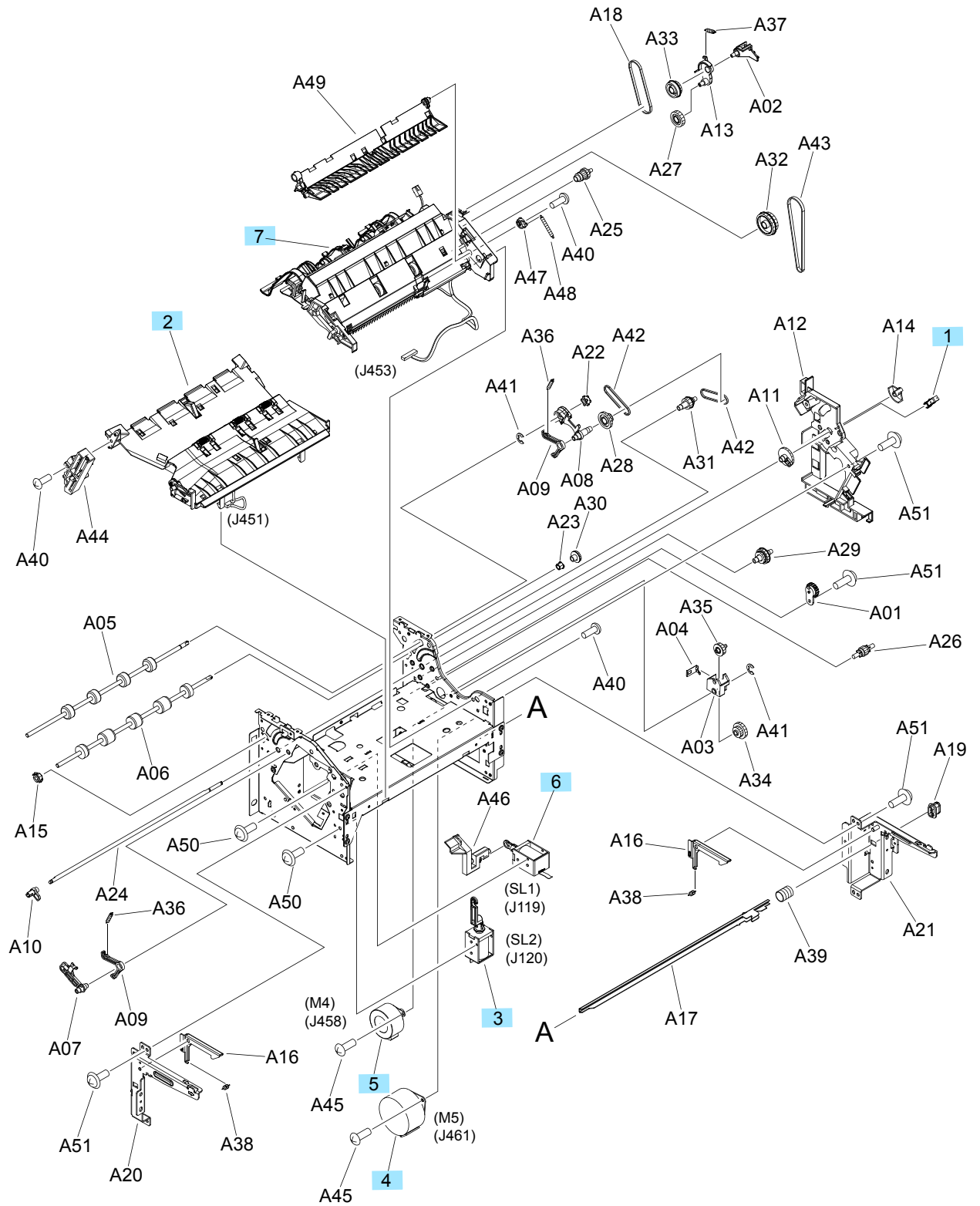

Table 2-31 Stapling mailbox assemblies (1 of 2)

Ref	Description	Part number	Qty
1	Photointerrupter	WG8-5935-000CN	1
2	Assembly, stage	RM1-5159-000CN	1
3	Assembly, entrance solenoid	RM1-6663-000CN	1
4	Motor, feed	RK2-2635-000CN	1
5	Motor, paddle	RK2-2637-000CN	1
6	Assembly, stamp solenoid	RM1-6664-000CN	1
7	Subassembly, stage top	RM1-7437-010CN	1