

# Internal components (4 of 9)

Figure 4-6 Internal components (4 of 9)

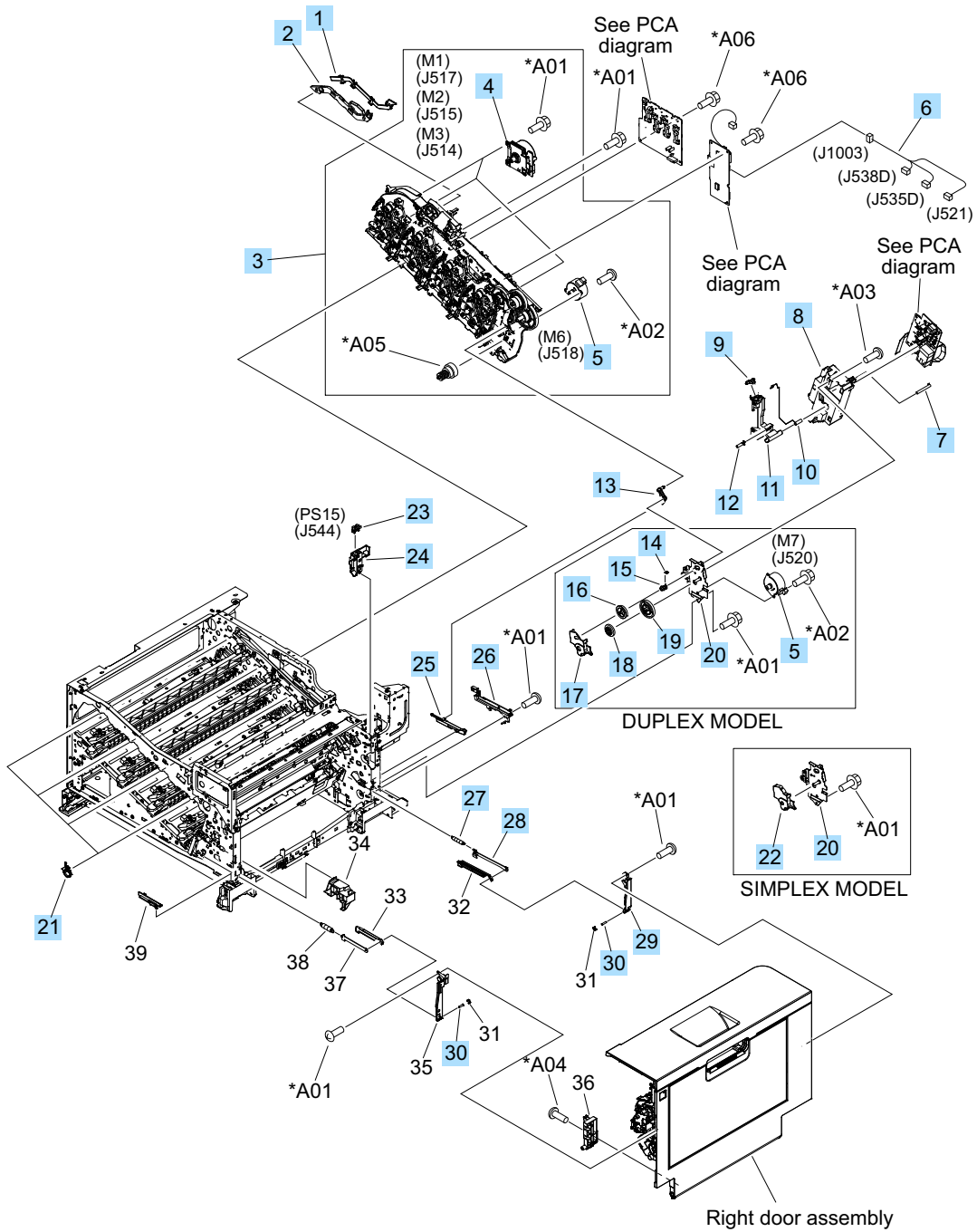

**Table 4-10 Internal components (4 of 9)**

<b>Ref</b>	<b>Description</b>	<b>Part number</b>	<b>Qty</b>
1	Cover, main drive cable, lower	RC2-6574-000CN	1
2	Guide, main drive cable	RC2-6659-000CN	1
3	Main drive assembly, duplex model	CE708-67901	1
3	Main drive assembly, simplex model	CE707-67905	1
4	DC motor assembly	RM1-6088-000CN	3
5	Motor, stepping, DC, duplex model	RK2-3298-000CN	2
5	Motor, stepping, DC, simplex model	RK2-3298-000CN	1
6	Cable, feed joint, duplex model	RM1-6846-000CN	1
7	Spring, grounding, second-transfer high-voltage PCA	RU6-2772-000CN	1
8	Holder, secondary transfer HVT	RC2-6681-010CN	1
9	Cap, T2 contact, second-transfer high-voltage PCA	RC2-6691-000CN	1
10	Spring, contact, second-transfer high-voltage PCA	RU6-2771-000CN	1
11	Holder, secondary transfer, power dispatching	RC2-6682-000CN	1
12	Spring, grounding, second-transfer high-voltage PCA	RC2-6700-000CN	1
13	Link, ITB coupling release	RC2-6823-000CN	1
14	Spring, tension, duplex model	RU6-2671-000CN	1
15	Hook, duplexing spring, duplex model	RC2-6932-000CN	1
16	Gear, 25T, duplex model	RU6-0771-000CN	1
17	Cover, duplexing gear, duplex model	RC2-6931-000CN	1
18	Gear, 25T, duplex model	RU6-0772-000CN	1
19	Gear, 74T, duplex model	RU6-0773-000CN	1
20	Plate, duplexing drive gear	RL1-2266-000CN	1
21	Support, developing coupling	RC2-6811-000CN	4
22	Cover, gear, simplex model	RC3-0688-000CN	1
23	Sensor, right door	WG8-5935-000	1
24	Holder, door sensor, right	RC2-6645-000CN	1
25	Arm, ITB coupling release	RC2-6824-000CN	1
26	Rail, door link, rear lower	RC2-6635-000CN	1
27	Spring, tension, rear	RU6-2744-000CN	1
28	Plate, right door link, rear	RC2-7273-000CN	1
29	Plate, right door link, fixed, rear	RL1-2282-000CN	1
30	Shaft, right door link	RU5-4979-000CN	2