

Internal assemblies (6 of 8)

Figure 2-21 Internal assemblies (6 of 8)

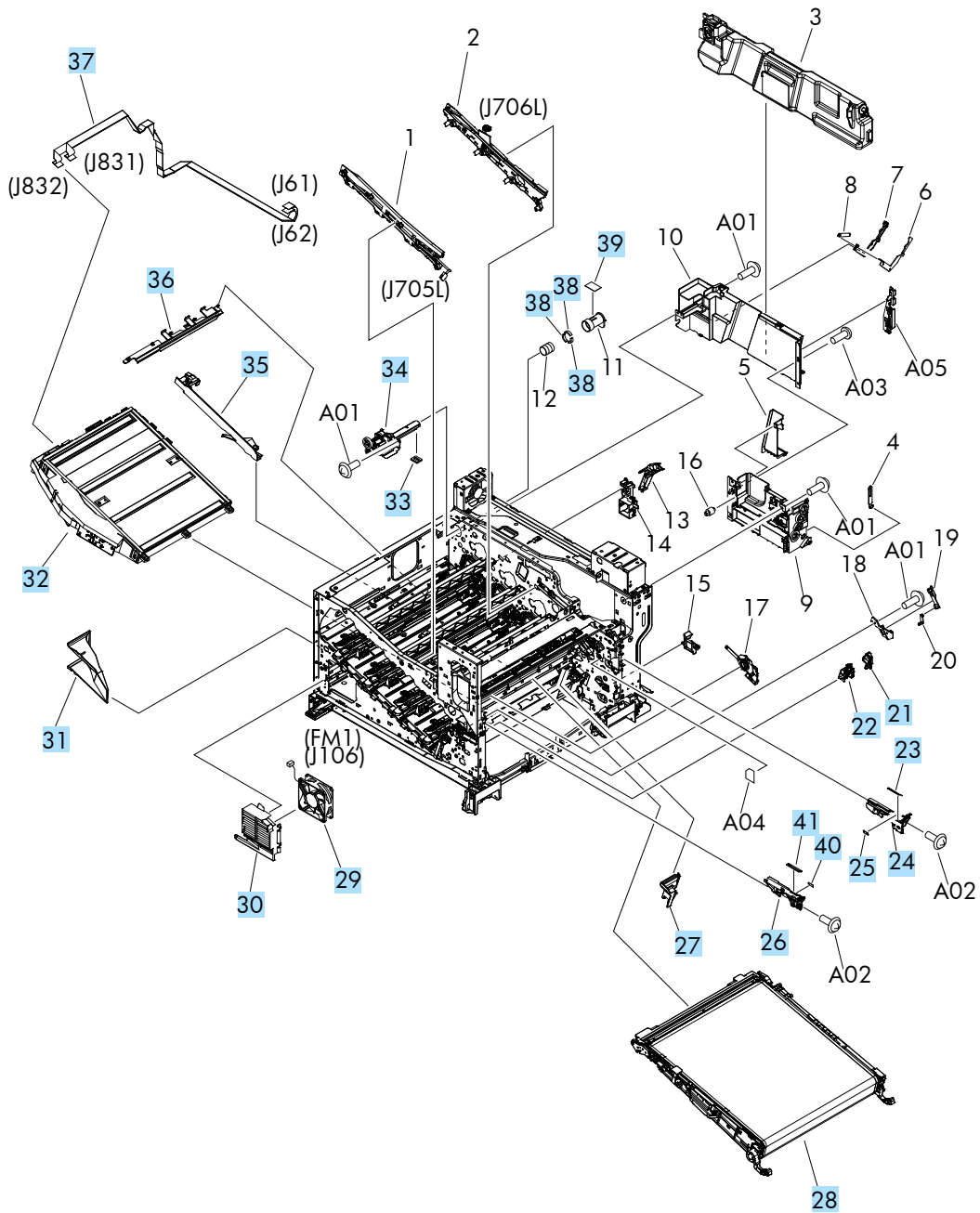

Table 2-24 Internal assemblies (6 of 8)

Ref	Description	Part number	Qty
21	Cover, main crossmember cable	RC2-6650-000CN	1
22	Guide, main crossmember cable	RC2-6600-000CN	1
23	Label, ITB set, RH	RU5-8807-000CN	1
24	Rail, ITB guide	RC2-7185-000CN	1
25	Label, ITB set, RV	RU5-8805-000CN	1
26	Rail, ITB guide, F3	RC2-7193-000CN	1
27	Guide, inside cable	RC2-6589-000CN	1
28	Kit, intermediate transfer belt (ITB) repair	CC522-67911	1
29	Fan (FM1; power supply)	RK2-2276-000CN	1
30	Holder, power supply fan	RC2-7299-000CN	1
31	Duct, fan, 1	RC2-8388-000CN	1
32	Laser/scanner assembly	RM1-6122-070CN	1
33	Seal, toner supporter guide	RC2-7018-000CN	1
34	Toner feed assembly	RM1-6040-010CN	1
35	Guide, laser	RC2-6628-000CN	1
36	Holder, flexible flat cable (FFC)	RC2-6655-000CN	1
37	FFC assembly	RM1-6804-000CN	1
38	Seal, slide shutter	RC3-1014-000CN	3
39	Sheet, slide seal	RC3-1013-000CN	1
40	Label, ITB insert, FV	RU5-8804-000CN	1
41	Label, ITB insert, FH	RU5-8806-000CN	1
Not shown	Lock plate, front	RL1-2235-000CN	1
Not shown	Lock plate, 2nd transfer	RL1-2236-000CN	1
Not shown	Spring, torsion	RU6-2670-000CN	2