

Internal assemblies (4 of 4)

Figure 3-6 Internal assemblies (4 of 4)

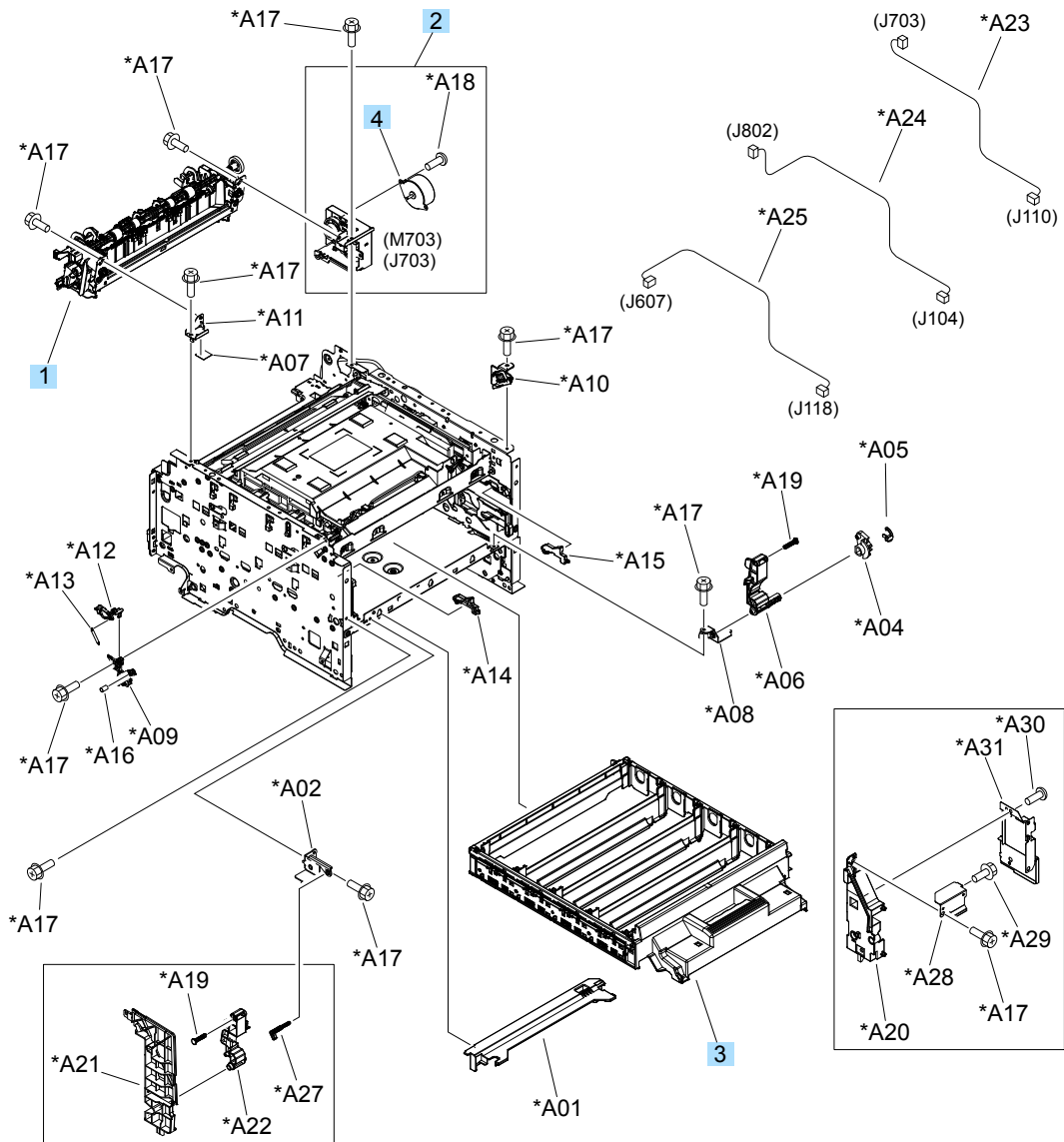

Table 3-12 Internal assemblies (4 of 4)

Ref	Description	Part number	Qty
1	Fuser assembly (110 to 127 v)	RM1-4430-000CN	1
1	Fuser assembly (220 to 240 v)	RM1-4431-000CN	1
2	Fuser drive assembly	RM1-4927-000CN	1
3	Cartridge tray assembly	RM1-7853-000CN	1
4	Motor, stepping DC fuser	RK2-1872-000CN	1