

## Covers, panels, and doors

Figure 3-2 Covers, panels, and doors

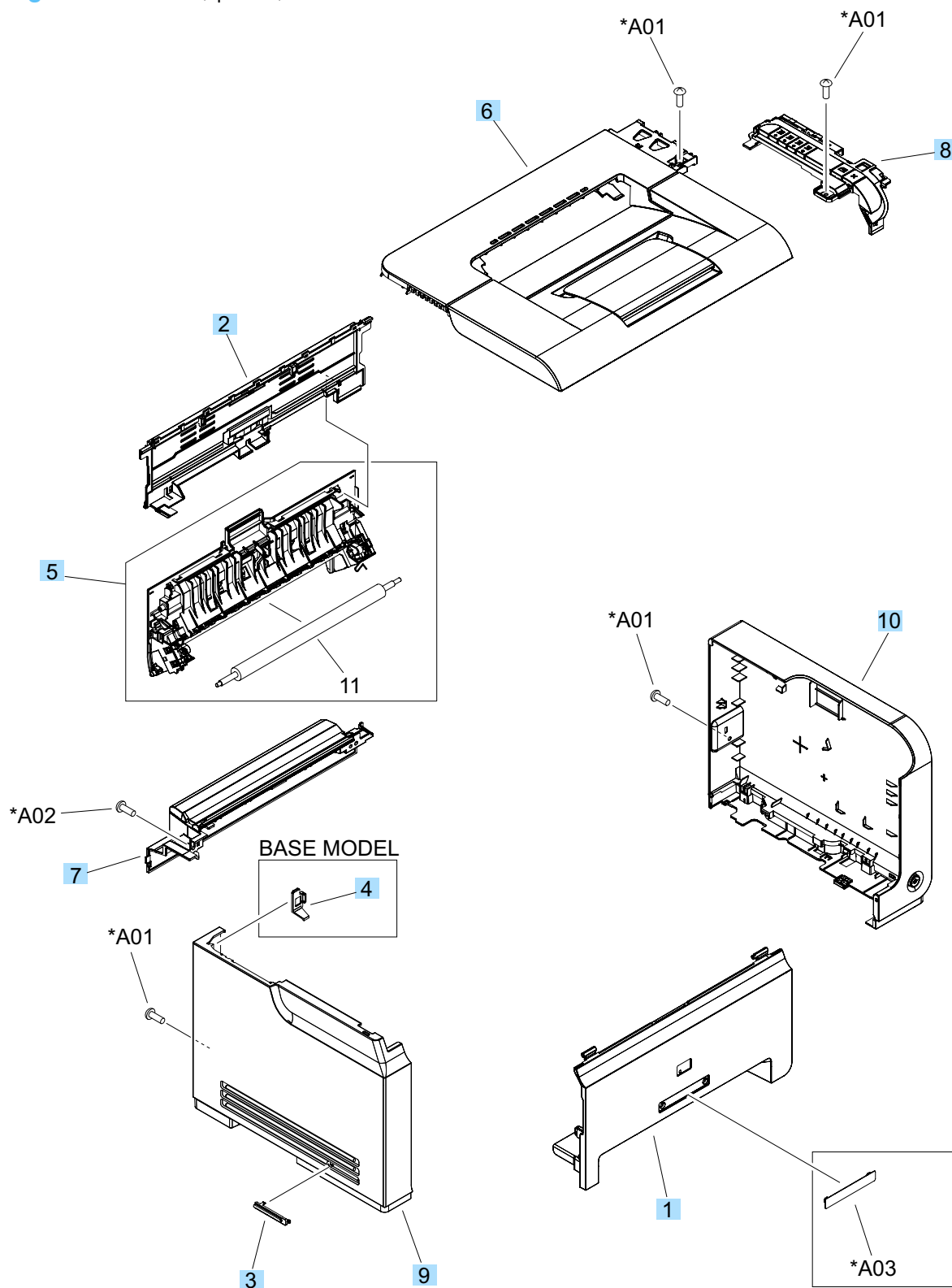

**Table 3-6 Covers, panels, and doors**

<b>Ref</b>	<b>Description</b>	<b>Part number</b>	<b>Qty</b>
1	Door, front (base model)	RM1-7219-000CN	1
1	Door, front (plus mode)	RM1-7275-000CN	1
2	Cover, fusing	RC2-9834-000CN	1
3	Cover, blanking	RC2-9866-000CN	1
4	Cover, network plug (base model)	RC2-9867-000CN	1
5	Rear cover/2nd transfer assembly	RM1-7216-000CN	1
6	Cover, top	RM1-7217-000CN	1
7	Cover, low-voltage power supply assembly	RM1-7273-000CN	1
8	Control panel assembly (base model)	RM1-7273-000CN	1
8	Control panel assembly (plus model)	RM1-7227-000CN	1
9	Cover, left	RM1-7231-000CN	1
10	Cover, right	RM1-7232-000CN	1
11	2ND Transfer roller assy.	RM1-7232-000CN	1