

Parts and diagrams Covers

Covers (M501/M506)

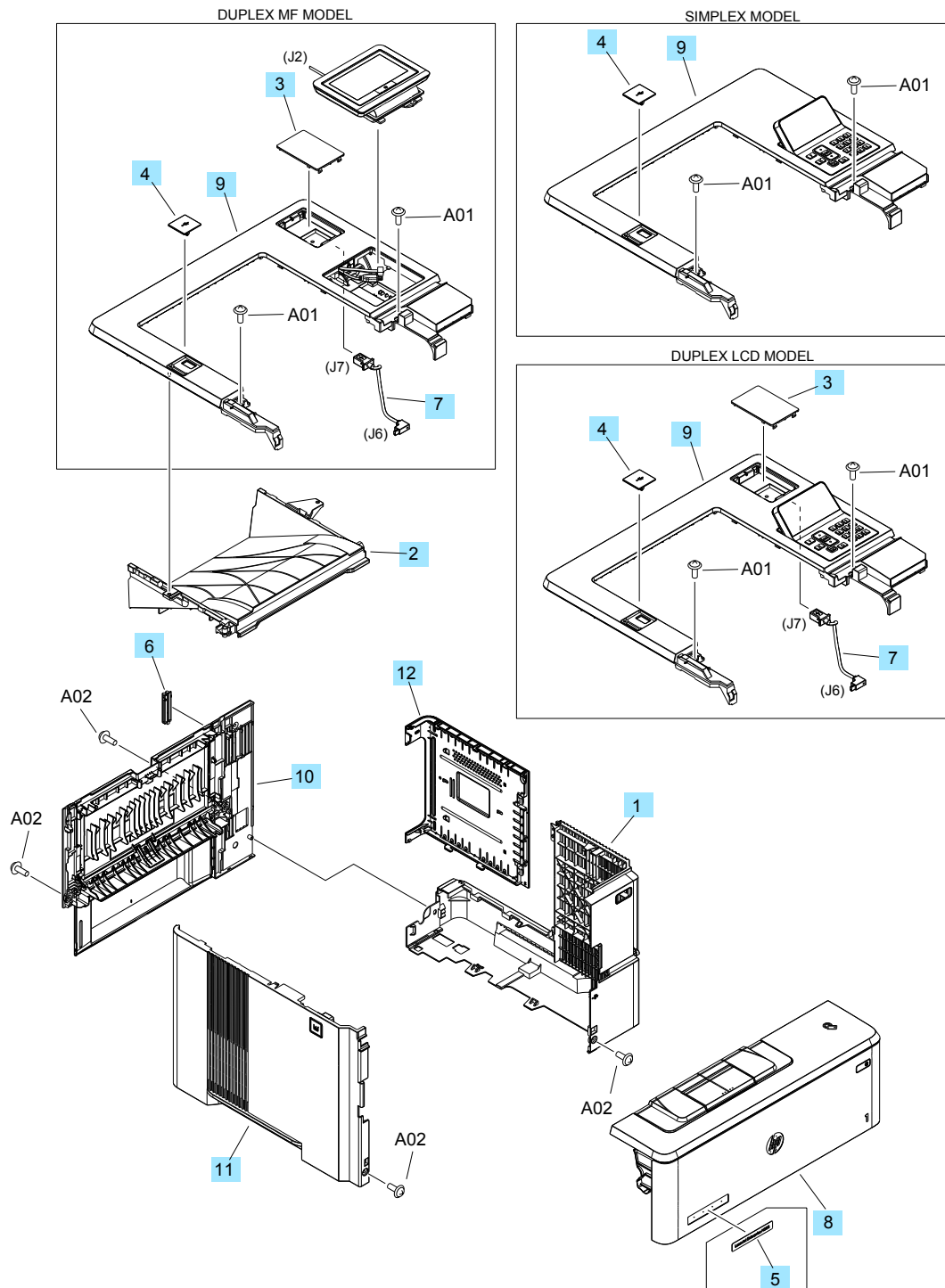

Table 2-5 Covers (M501/M506)

Ref	Description	Part number	Qty
1	Cover, right (M501/M506)	RC4-4437-000CN	1
2	Tray, paper delivery output bin (M501/M506)	RC4-4439-000CN	1
3	Cover, HIP (M506 duplex models)	RC4-4142-000CN	1
4	Cover, USB (M506)	RC4-4149-000CN	1
5	Plate, name (M506)	F2A68-40002	1
5	Plate, name (M501)	J8H60-40001	1
6	Cover, I/O (M506)	RC4-4433-000CN	1
7	Cable, HIP (M506 duplex models)	RK2-7104-000CN	1
8	Door, cartridge kit (M506n/dn)	F2A68-67919	1
8	Door, cartridge kit (M506x)	F2A68-67920	1
8	Door, cartridge (M501)	RM2-5677-000CN	1
Not shown	Cover, top (M501)	RM2-5735-000CN	1
9	Cover, top (M506 simplex models)	RM2-5687-000CN	1
9	Cover, top (M506 duplex LCD models)	RM2-5699-000CN	1
9	Cover, top (M506 duplex MF models)	RM2-5686-000CN	1
9	Cover, top (M501 duplex models)	RM2-5726-000CN	1
10	Door, rear (M501/M506 simplex models)	RM2-5712-000CN	1
10	Door, rear (M501/M506 duplex models)	RM2-5711-000CN	1
11	Cover, left (M501/M506)	RM2-5727-000CN	1
11	Cover, formatter (M501)	RC4-4200-000CN	1
11	Cover, formatter (M506)	RM2-5725-000CN	1
Not shown	Hinge, cartridge door left	RC4-3010-000CN	1
Not shown	Link, pressure release (cartridge door)	RC4-4479-000CN	1