

Internal components (1 of 4)

Figure 7-19 Internal components (1 of 4)

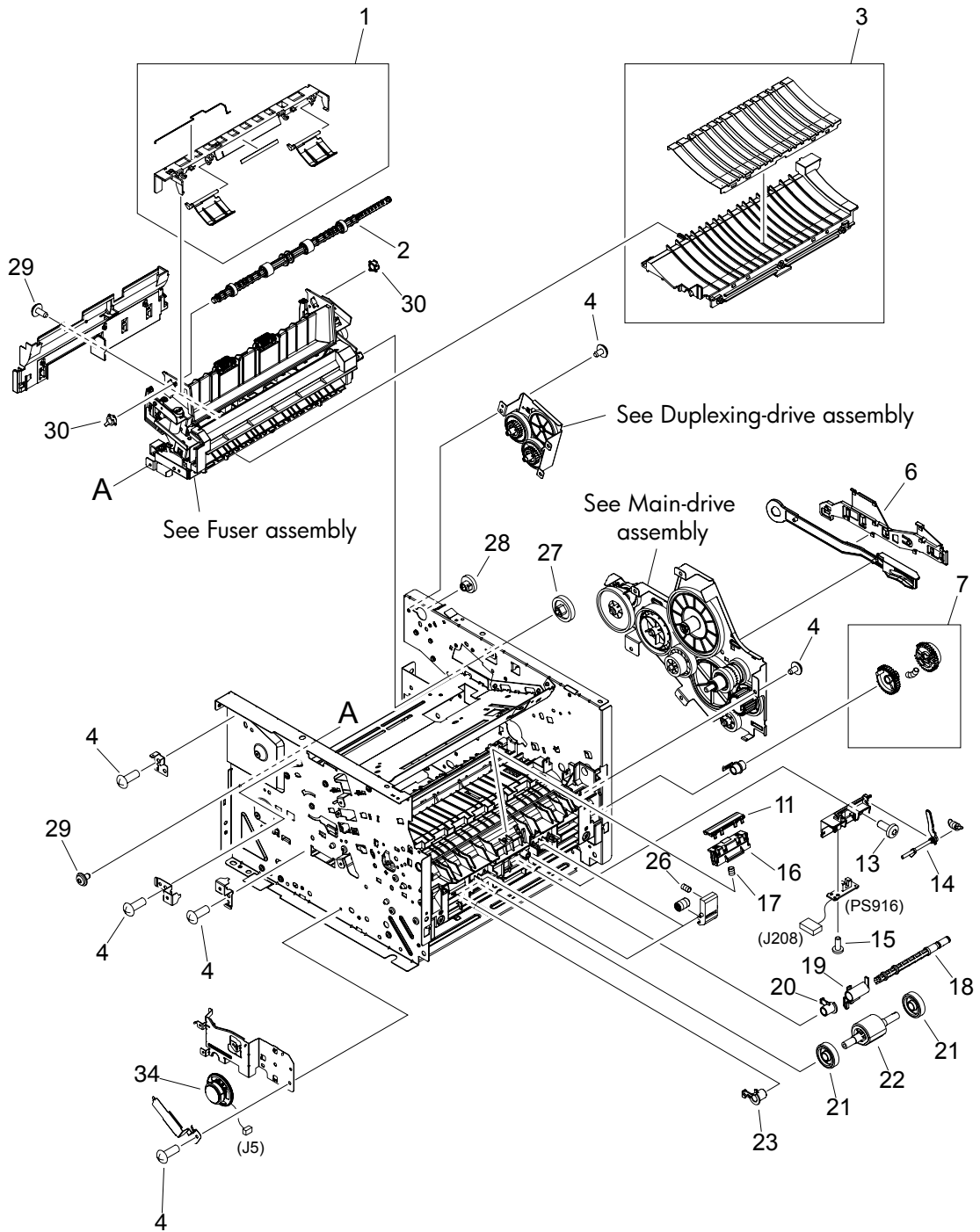

Table 7-25 Internal components (1 of 4)

| Ref | Description | Part number | Qty |
|-----|----------------------------------|----------------|-----|
| 1 | Paper-retaining assembly | RM1-4265-000CN | 1 |
| 2 | Roller, face down | RL1-0527-000CN | 1 |
| 3 | Paper-feed guide assembly | RM1-4263-000CN | 1 |
| 4 | Screw, RS M3X6 | XA9-1495-000CN | 12 |
| 6 | Guide, DC cable 2 | RC2-1569-000CN | 1 |
| 7 | Paper-pickup gear assembly | RM1-1301-000CN | 1 |
| 11 | MP separation pad (Tray 1) | RL1-1524-000CN | 1 |
| 13 | Screw, tapping truss head M4X10 | XB4-7401-000CN | 1 |
| 15 | Screw, tapping binding head M3X8 | XB4-7300-000CN | 1 |
| 16 | Separation pad base | RC2-0419-000CN | 1 |
| 17 | Spring, compression | RU5-2894-000CN | 1 |
| 18 | Paper-pickup drive shaft | RC1-3471-000CN | 1 |
| 19 | Flag, paper sensing | RC1-3472-000CN | 1 |
| 20 | Right bushing | RB2-2895-000CN | 1 |
| 21 | Roller, paper-pickup idler | RC1-3470-000CN | 2 |
| 22 | Roller, paper pickup | RL1-0540-000CN | 1 |
| 23 | Left bushing | RB2-2896-000CN | 1 |
| 26 | Spring, compression | RU5-2323-000CN | 2 |
| 27 | Gear, 29T | RU5-0331-000CN | 1 |
| 28 | Gear, 19T | RU5-0332-000CN | 1 |
| 29 | Screw, tap M3X6 | XA9-1503-000CN | 5 |
| 30 | Bushing | RC1-3665-000CN | 2 |
| 34 | Speaker assembly | RM1-4943-000CN | 1 |