

Paper pickup assembly (HCI)

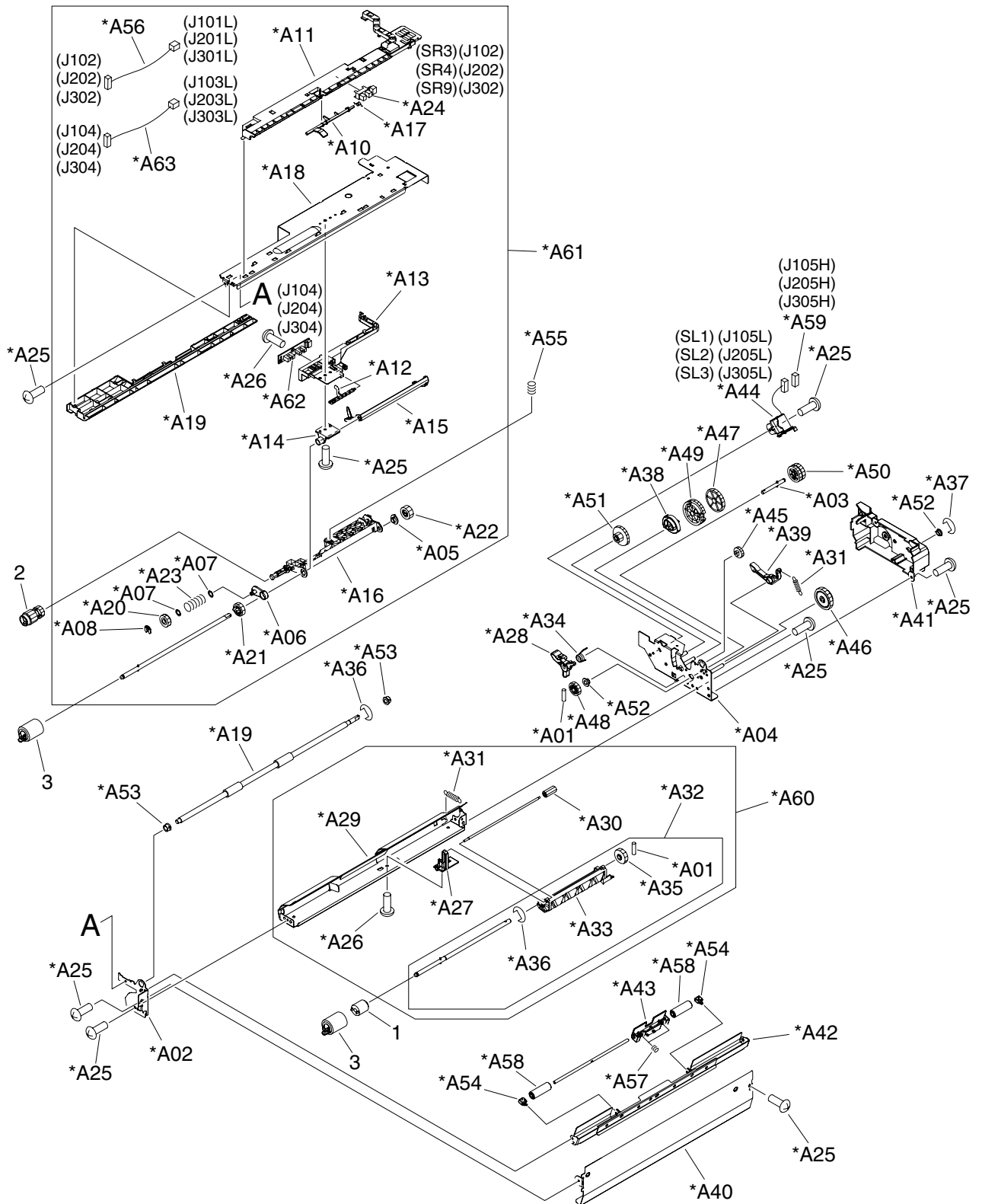

Figure 7-43 Paper pickup assembly (HCI)

Table 7-45 Paper pickup assembly (HCI)

Ref	Description	Part number	Qty
All	Paper pickup assembly (1X500 HCI)	RM1-3821-000CN	1
All	Paper pickup assembly (3X500)	RM1-3821-000CN	3
1	Limiters, torque		1
2	Roller, pickup	RL1-1206-000CN	1
3	Paper feed roller assembly	RL1-0037-000CN	2
A01	Pin, dowel		2
A02	Side plate, paper pickup fr.		1
A03	Shaft, retard link		1
A04	Side plate, pickup drive		1
A05	Bushing		1
A06	Plate, swing		1
A07	Slider, polyester		2
A08	Ring, retaining		1
A09	Guide, jam clearing		1
A10	Flag, jam sensor		1
A11	Guide, paper pickup upper		a
A12	Flag, paper yes/no sensor		1
A13	Holder, sheet sensor		1
A14	Holder, pick arm		1
A15	Flag, paper level sensor		1
A16	Arm, pick		1
A17	Spring, torsion		1
A18	Plate, paper pickup upper		1
A19	Roller, paper feed		1
A20	Gear, 14T		1
A21	Gear, 23T		1
A22	Gear, 17T		1
A23	Spring, compression		1
A24	Photo interrupter, TLP1243		1
A25	Screw, TP, M3X6		12
A26	Screw, tap, binding head, M3X8		2
A27	Plate, retard busing		1
A28	Lever, nip pressure release		1
A29	Guide, paper pickup lower		1

Ref	Description	Part number	Qty
A30	Gear, 14T		1
A31	Spring, tension		2
A32	Retard holder assembly		1
A33	Holder, retard		1
A34	Spring, torsion		1
A35	Gear, 37T		1
A36	Ring, E		2
A37	Ring, E		1
A38	Cam, pick		1
A39	Lever, trigger		1
A40	Guide, pickup vertical feed		1
A41	Cover, paper pickup gear		1
A42	Plate, feed roller mounting		1
A43	Arm, feed roller pressure		1
A44	Solenoid		1
A45	Gear, 14T		1
A46	Gear, 20T/33T		1
A47	Gear, 60T		1
A48	Gear, 33T		1
A49	Gear, 37T		1
A50	Gear, 24T/42T		1
A51	Gear, 21T/62T		1
A52	Bushing		2
A53	Bushing		2
A54	Bushing		2
A55	Spring, compression		1
A56	Cable, pickup opt. jam sensor		1
A57	Spring, compression		2
A58	Roller, paper feed		2
A59	Connector, snap tight, BK		1
A60	Paper pickup LW guide assembly		1
A61	Paper pickup UP plate assembly		1
A62	Option paper sensor PCA assembly		1
A63	Cable, OPT sensor PCA connect		1