

Upper cassette pickup assembly (print engine)

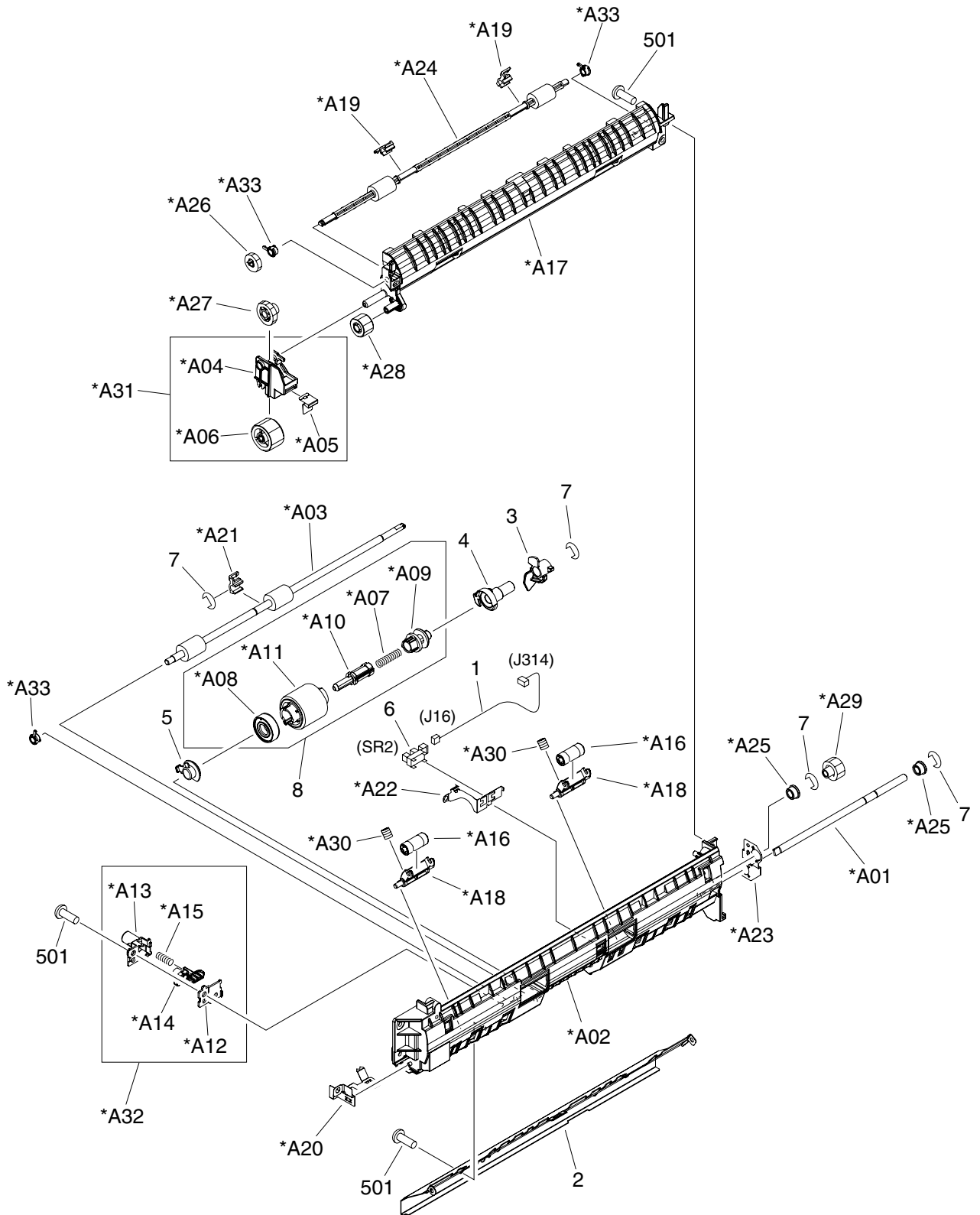

Figure 7-32 Upper cassette pickup assembly (print engine)

Table 7-34 Upper cassette pickup assembly (print engine)

Ref	Description	Part number	Qty
All	Upper cassette paper pickup assembly (engine)	RM1-2976-000CN	1
1	Cable, cassette sensor, upper		1
2	Guide, paper re-pick up		1
3	Lever, paper sensor		1
4	Bushing		1
5	Bushing		1
6	Photo interrupter, TLP1243	WG8-5696-000CN	1
7	Ring, E		4
8	Paper pickup roller assembly	RM1-2988-000CN	1
501	Screw, tapping, truss head, M4X10		6
A01	Shaft, paper pickup drive		1
A02	Frame, paper pickup, upper		1
A03	Shaft, roller, upper		1
A04	Arm, pendulum		1
A05	Spring, leaf		1
A06	Gear, 23T		1
A07	Spring, compression		1
A08	Cap, paper pickup, left		1
A09	Core, paper pickup roller		1
A10	Shaft, cassette slide		1
A11	Roller, cassette paper pickup		1
A12	Case, roller stopper		1
A13	Case, roller stopper		1
A14	Lever, roller stopper		1
A15	Spring, compression		1
A16	Roller, idler		2
A17	Guide, paper re-pickup, upper		1
A18	Holder, paper re-pickup roller		2
A19	Bushing		2
A20	Spring, grounding		1
A21	Bushing		1
A22	Plate, sensor grounding		1
A23	Plate, roller grounding, upper		1
A24	Roller, paper re-pickup		1

Ref	Description	Part number	Qty
A25	Bushing		2
A26	Gear, 14T		1
A27	Gear, 19T		1
A28	Gear, 15T		1
A29	Gear, 16T		1
A30	Spring, compression		2
A31	Pendulum arm assembly		1
A32	Roller stopper assembly		1
A33	Bushing		3



NOTE Not all components listed in the parts tables can be ordered. If a component listed has an associated part number, then it is a field replaceable unit (FRU) and can be ordered. If the component does not have an associated part number, you must order the FRU that includes the desired component.

